

SCHEDULED SERVICES - GASOLINE

1988 Jeep Cherokee

1984-88 MAINTENANCE
AMC/Jeep Maintenance & Service Intervals - Gasoline
Jeep; Cherokee, Wagoneer

* PLEASE READ THIS FIRST *

NOTE: All SERVICE SCHEDULES are listed for normal service vehicles. If vehicle is operated under severe service conditions, see SEVERE SERVICE REQUIREMENTS (PERFORM W/SERVICE SCHEDULES) for items requiring additional maintenance.

NOTE: This article contains scheduled maintenance service information. Fluid types and capacities listed with each service in this article are only those necessary to perform that scheduled service. For specifications pertaining to fluid capacities for the entire vehicle, fuse and circuit breaker identification, wheel and tire size, battery type, warranty information, or model identification refer to the MAINTENANCE INFORMATION article in this section.

CAUTIONS & WARNINGS

AIR CONDITIONING MAINTENANCE

WARNING: NEVER add A/C refrigerant to correct a non-cooling problem unless pressure gauges are connected to the system by a certified technician. Lack of cooling may be caused by a restriction, therefore adding refrigerant can cause a dangerous pressure rise.

ANTI-LOCK BRAKE SYSTEM (If Equipped)

The anti-lock brake system contains electronic equipment that can be susceptible to interference caused by improperly installed or high output radio transmitting equipment. Since this interference could cause the possible loss of the anti-lock braking capability, such equipment should be installed by qualified professionals.

On models equipped with anti-lock brake systems, ALWAYS observe the following cautions:

- * DO NOT attempt to bleed hydraulic system without first referring to the appropriate ANTI-LOCK BRAKE SYSTEM article in the BRAKES Section.
- * DO NOT mix tire sizes. As long as tires remain close to the original diameter, increasing the width is acceptable. Rolling diameter must be identical for all 4 tires. Some manufacturers recommend tires of the same brand, style and type. Failure to follow this precaution may cause inaccurate wheel speed readings.
- * Use ONLY recommended brake fluids. DO NOT use silicone brake fluids in an ABS-equipped vehicle.

BATTERY WARNING

WARNING: When battery is disconnected, vehicles equipped with

computers may lose memory data. When battery power is restored, driveability problems may exist on some vehicles. These vehicles may require a relearn procedure. See COMPUTER RELEARN PROCEDURES article in GENERAL INFORMATION section.

REPLACING BLOWN FUSES

Before replacing a blown fuse, remove ignition key, turn off all lights and accessories to avoid damaging the electrical system. Be sure to use fuse with the correct indicated amperage rating. The use of an incorrect amperage rating fuse may result in a dangerous electrical system overload.

BRAKE PAD WEAR INDICATOR

Indicator will cause a squealing or scraping noise, warning that brake pads need replacement.

BRAKE WARNING LIGHT

CAUTION: If BRAKE warning light is on with parking brake disengaged and engine running, there may be a problem in the hydraulic brake system. Braking effort, brake pedal travel and stopping distances may increase.

CATALYTIC CONVERTER

To prevent catalytic converter overheating, DO NOT allow engine to idle for more than 20 minutes.

COMMAND-TRAC (4WD)

CAUTION: NEVER operate a Command-Trac vehicle in 4WD on dry, hard-surfaced roads for a sustained period. Use 4L only when needed for added pulling power. Operating vehicle in 4WD mode on such roads will cause stress and possible damage to components, as well as make shifting difficult. To reduce shifting effort, drive vehicle in Reverse for a few feet, or drive off hard-surfaced road momentarily to allow tire slippage.

FRONT AND REAR DIFFERENTIALS (4WD)

CAUTION: DO NOT use water, steam, kerosene or gasoline for flushing a differential. ONLY use a flushing oil.

TRAC-LOK DIFFERENTIALS (4WD)

CAUTION: DO NOT flush a rear axle Trac-Lok differential. Trac-Lok differentials may be cleaned only by disassembling the unit and wiping the components with clean, lint-free cloth.

CAUTION: NEVER attempt to engage Low range when vehicle is moving faster than 2-3 MPH, as transfer case damage may result.

GASOLINE CONTAINING ALCOHOL

CAUTION: Exclusive use of gasohol is not recommended. Vehicle test results have shown that significant fuel system corrosion can result when gasohol is used exclusively.

HALOGEN BULBS

Halogen bulbs contain pressurized gas which may explode if overheated. DO NOT touch glass portion of bulb with bare hands. Eye protection should be worn when handling or working around halogen bulbs.

OIL FILTER

CAUTION: The engine oil filter mount has metric threads. Use of a filter with improper threads can result in oil leakage and possible engine damage. Look for M20 x 1.5 symbol on the filter.

RADIATOR CAP

CAUTION: Always disconnect the fan motor when working near the radiator fan. The fan is temperature controlled and could start at any time even when the ignition key is in the OFF position. DO NOT loosen or remove radiator cap when cooling system is hot.

RADIATOR FAN

Keep hands away from radiator fan. Fan is controlled by a thermostatic switch which may come on or run for up to 15 minutes even after engine is turned off.

WHEEL & TIRE WARNINGS

CAUTION: Replacing original tires with different size tires may result in false speedometer and odometer indications. Check with dealer before using different size tires on vehicle.

CAUTION: Ensure all 4 wheels on vehicle have same tire size, type and circumference in order to provide proper vehicle handling. DO NOT mix radial-ply with bias-ply or bias-belted tires. On 4WD vehicles, if tire size, type and circumference on all 4 wheels are not the same, gear shifting will be adversely affected and can damage transfer case.

CAUTION: Temporary-use spare tires are for emergency use only. DO NOT drive vehicle faster than 50 MPH or more than 100 miles when using spare tire. DO NOT operate vehicle in 4WD mode when using spare tire, as damage to transfer case can result. Temporary-use spare tires have a total tread life of 3,000 miles.

SERVICE POINT LOCATIONS

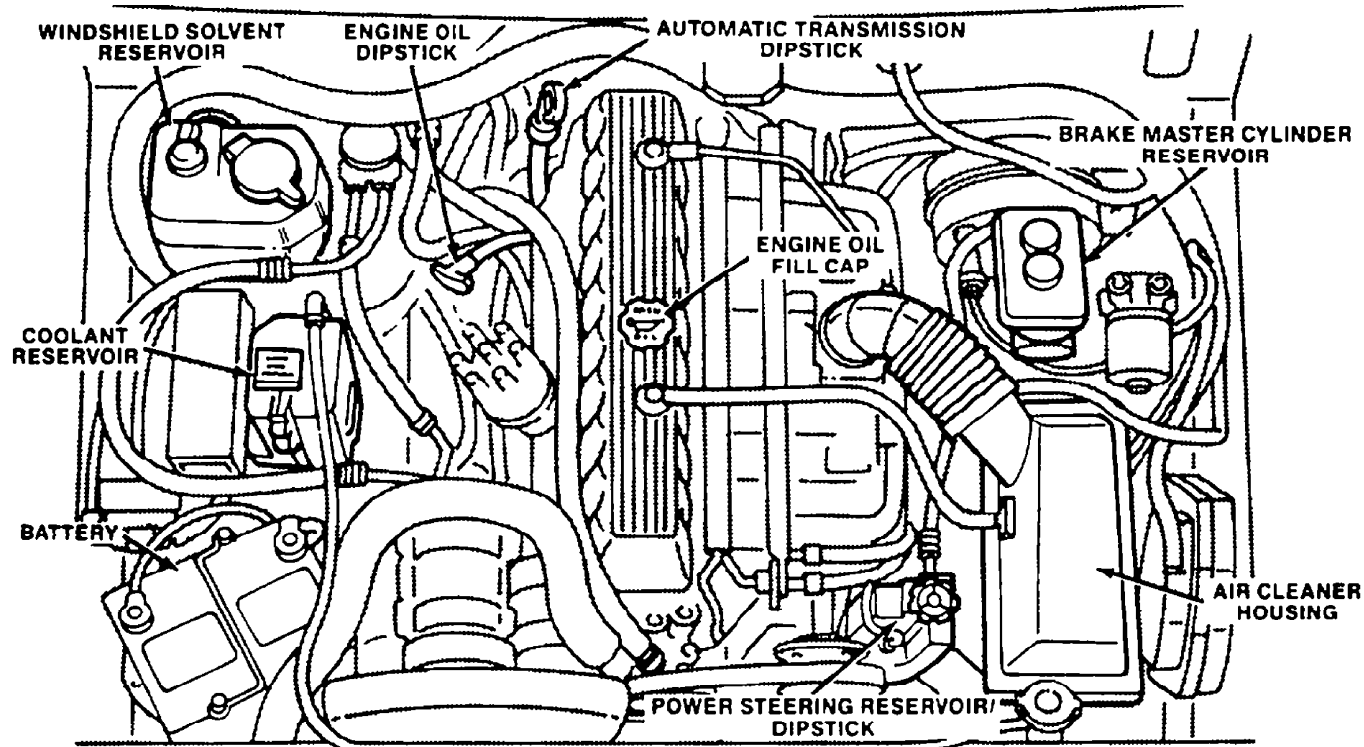

5011724

Fig. 1: Service Point Locations (Typical)
Courtesy of American Motors Corp.

ADDITIONAL SERVICE INFORMATION

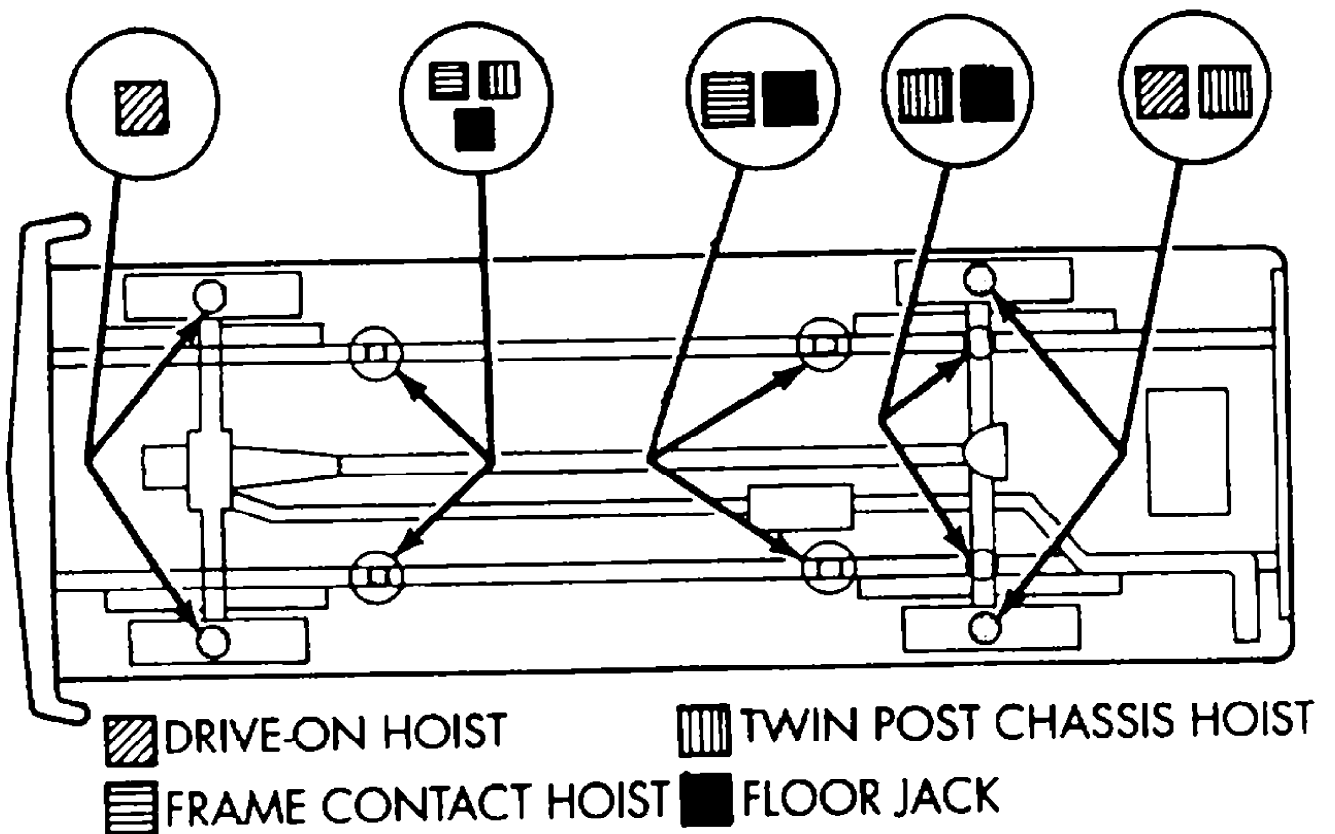
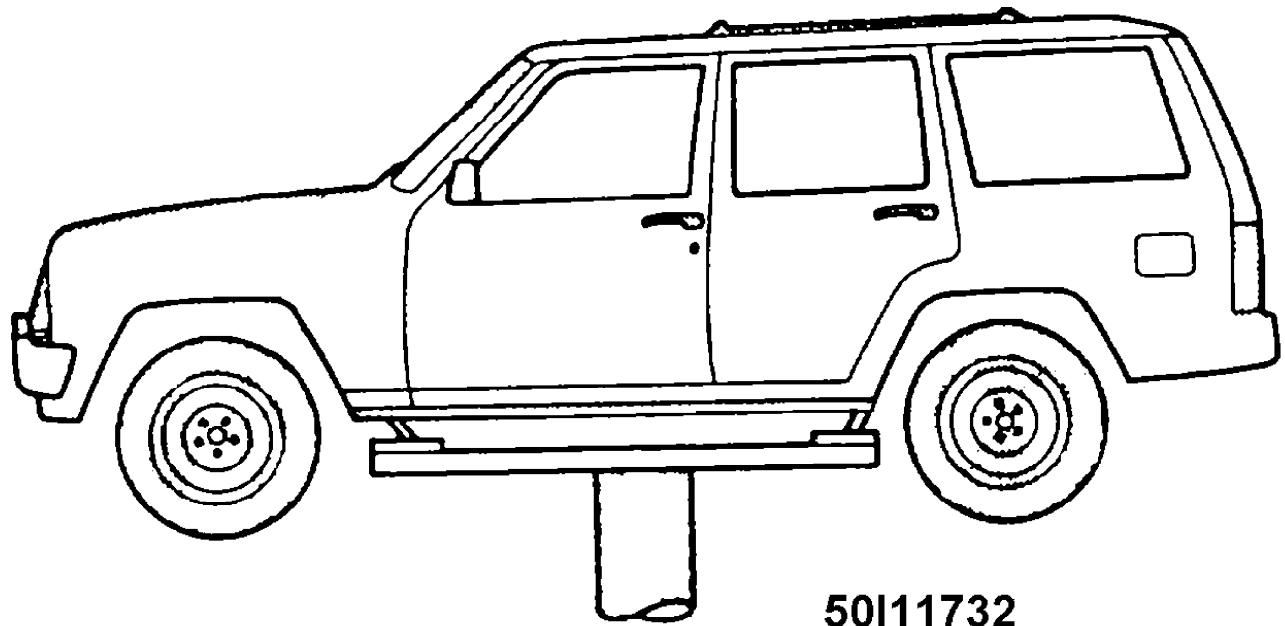
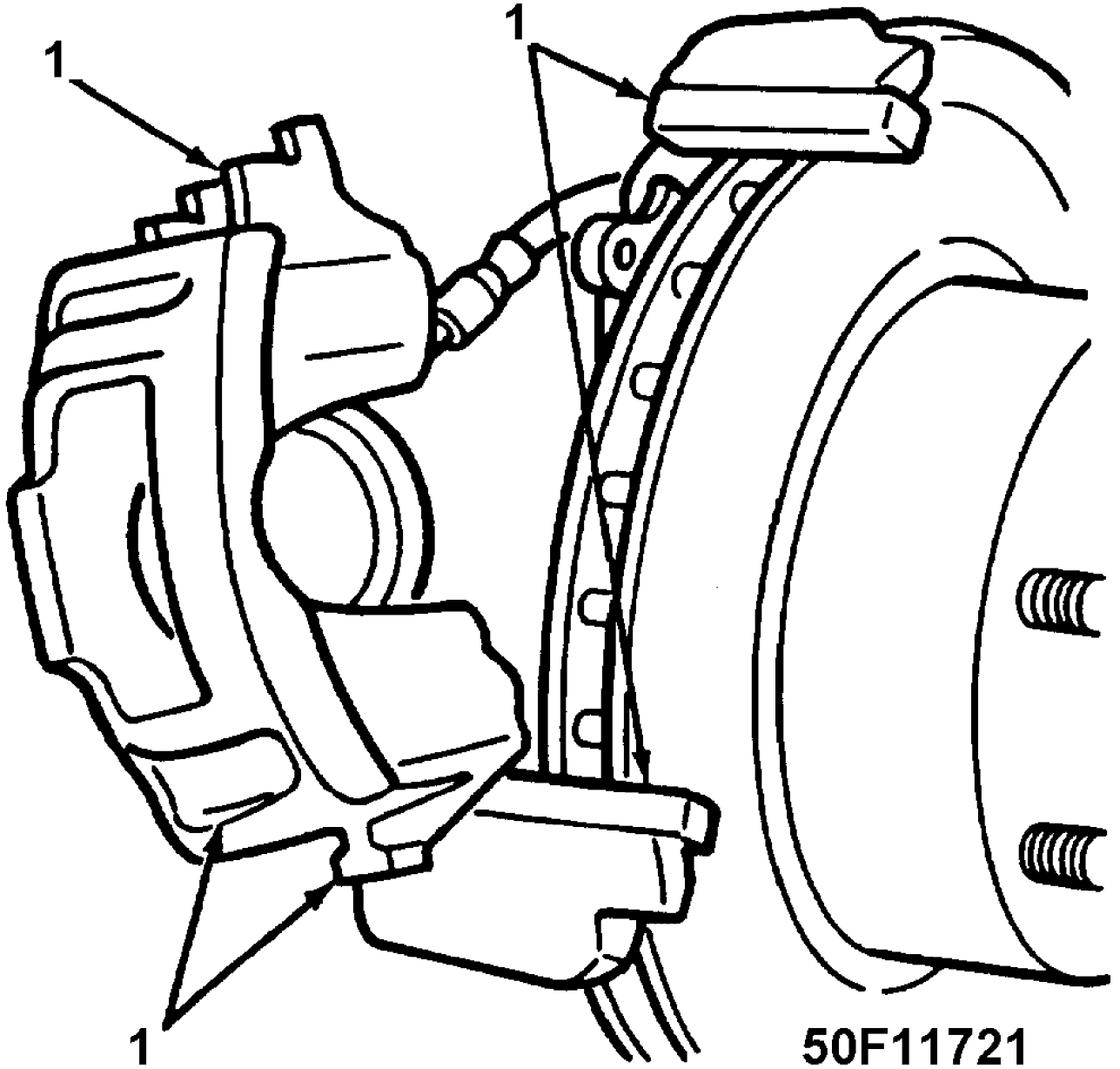

Fig. 2: Hoist Lift Point Locations
 Courtesy of American Motors Corp.

NOTE: For more information regarding jacking and hoisting refer to the JACKING & HOISTING article in the

WHEEL ALIGNMENT section.



1. LUBRICATION POINTS

Fig. 3: Brake Caliper Lubrication Points
Courtesy of American Motors Corp.

NOTE: For more information regarding brake maintenance refer to the BRAKE SYSTEM article.

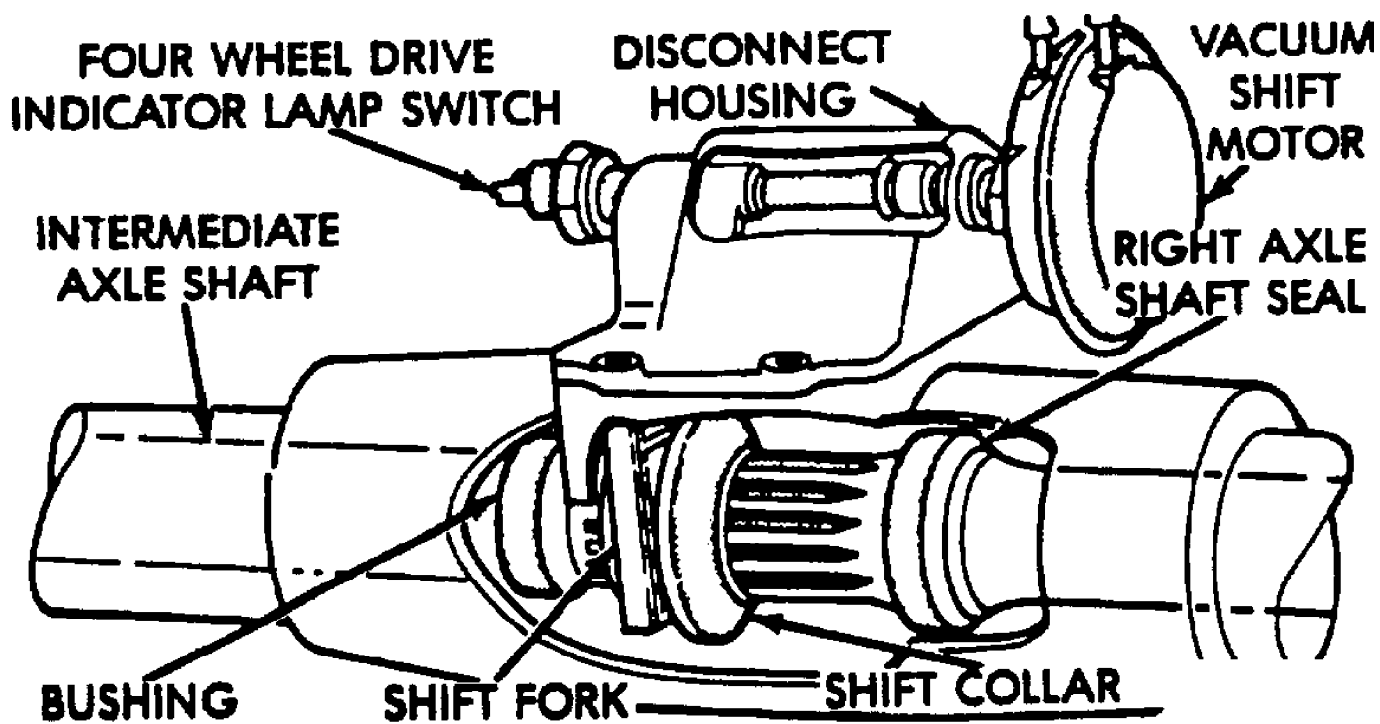

50J11733

Fig. 4: Front Disconnect Housing Lubrication Point
 Courtesy of American Motors Corp.

IDENTIFICATION LABEL LOCATIONS

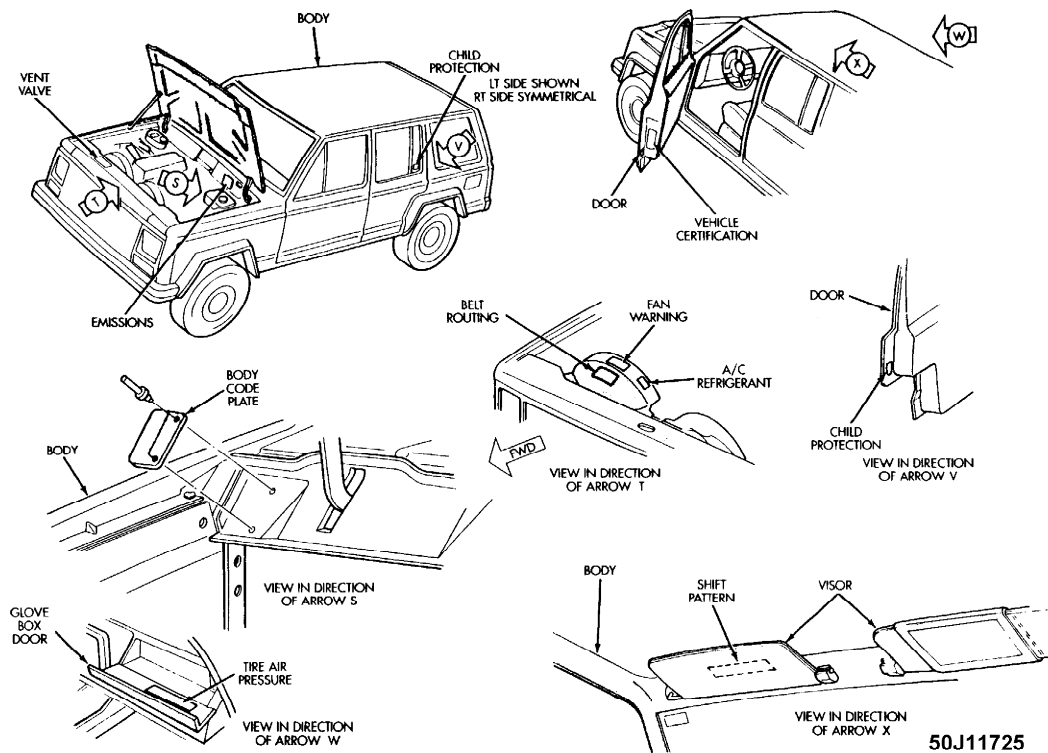

VEHICLE, LABELS AND PLATES

Fig. 5: Identification Label Locations
 Courtesy of American Motors Corp.

SPARK PLUG REPLACEMENT INTERVALS

Spark plug replacement intervals, if given, are for Original Equipment Manufacturer (OEM) installed or specified plugs. If vehicle is equipped with platinum type or other non-OEM type spark plugs, follow replacement interval specified by spark plug manufacturer.

OXYGEN SENSOR

If vehicle is equipped with an oxygen sensor, replace at 82,500 miles or when the emissions maintenance reminder light remains on continuously with the key in the ON position, whichever occurs first.

SEVERE & NORMAL SERVICE DEFINITIONS

CAUTION: Use the Severe Service schedule if the vehicle to be serviced is operated under ANY (one or more) of these conditions:

Service is recommended at mileage intervals based on vehicle operation. Normal Service and Severe Service are based on the following primary operating conditions:

Severe Service

- * Short Trips (About 15 Miles)
- * Desert Or Cold Climate Operation
- * Towing Or Heavily Loaded
- * Severe Dust Conditions
- * Hot Weather, Stop-And-Go Driving

- * Sustained High Speed Driving
- * Extensive Idling Conditions (Taxi Or Delivery-Type Service)
- * Driving Off-Road Or In Salty Or Sandy Areas
- * Driving In Water

Normal Service

- * Driven More Than 10 Miles Daily
- * No Severe Service Operating Conditions

SEVERE SERVICE REQUIREMENTS (PERFORM W/SERVICE SCHEDULES)

NOTE: The following services are to be performed on vehicles subjected to severe service. See SEVERE & NORMAL SERVICE DEFINITIONS. This service is to be performed in addition to the normal services listed in the NORMAL MAINTENANCE SERVICE SCHEDULES.

SEVERE SERVICE CONDITIONS/ACTIONS TABLE

Condition	Action	Item	Perform Every (1)
Short Trips (About 15 Miles)	Replace	Engine Oil	3,000 Miles or 3 Months
	Replace	Engine Oil Filter	6,000 Miles or 6 Months
	Service	Lube Prop Shaft If Equipped With Fittings	3,000 Miles
	Replace	A/T Fluid	12,000 Miles
	Replace	Front And/Or Rear Axle Oil	12,000 Miles
	Replace	M/T Fluid Oil	18,000 Miles
Desert Or Cold Climate Operations	Replace	Engine Oil	3,000 Miles or 3 Months
	Replace	Engine Oil Filter	6,000 Miles or 6 Months
	Service	Lube Prop Shaft If Equipped With Fittings	3,000 Miles
	Replace	A/T Fluid	12,000 Miles
	Replace	Front And/Or Rear Axle Oil	12,000 Miles
	Replace	M/T Fluid Oil	18,000 Miles
Towing Or Heavily Loaded	Replace	Engine Oil	3,000 Miles or 3 Months
	Replace	Engine Oil Filter	6,000 Miles or 6 Months
	Service	Lube Prop	3,000 Miles

		Shaft If Equipped With Fittings	
	Replace	A/T Fluid	12,000 Miles
	Replace	Front And/Or Rear Axle Oil	12,000 Miles
	Replace	M/T Fluid Oil	18,000 Miles
Severe Dust Conditions	Replace	Engine Oil	3,000 Miles or 3 Months
	Replace	Engine Oil Filter	6,000 Miles or 6 Months
	Service	Lube Prop Shaft If Equipped With Fittings	3,000 Miles
	Replace	A/T Fluid	12,000 Miles
	Replace	Front And/Or Rear Axle Oil	12,000 Miles
	Replace	M/T Fluid Oil	18,000 Miles
Hot Weather, Stop-And-Go Driving	Replace	Engine Oil	3,000 Miles or 3 Months
	Replace	Engine Oil Filter	6,000 Miles or 6 Months
	Service	Lube Prop Shaft If Equipped With Fittings	3,000 Miles
	Replace	A/T Fluid	12,000 Miles
	Replace	Front And/Or Rear Axle Oil	12,000 Miles
	Replace	M/T Fluid Oil	18,000 Miles
Sustained High Speed Driving	Replace	Engine Oil	3,000 Miles or 3 Months
	Replace	Engine Oil Filter	6,000 Miles or 6 Months
	Service	Lube Prop Shaft If Equipped With Fittings	3,000 Miles
	Replace	A/T Fluid	12,000 Miles
	Replace	Front And/Or Rear Axle Oil	12,000 Miles
	Replace	M/T Fluid Oil	18,000 Miles
Extensive Idling	Replace	Engine Oil	3,000 Miles or 3 Months

Conditions (Taxi Or Delivery Type Service)	Replace	Engine Oil Filter	6,000 Miles or 6 Months
	Service	Lube Prop Shaft If Equipped With Fittings	3,000 Miles
	Replace	A/T Fluid	12,000 Miles
	Replace	Front And/Or Rear Axle Oil	12,000 Miles
	Replace	M/T Fluid Oil	18,000 Miles
Driving Off-Road Or In Salty Or Sandy Areas	Replace	Engine Oil	3,000 Miles or 3 Months
	Replace	Engine Oil Filter	6,000 Miles or 6 Months
	Replace	4WD: Engine Oil	50 Hours
	Service	Lube Prop Shaft If Equipped With Fittings	3,000 Miles
	Replace	A/T Fluid	12,000 Miles
	Replace	Front And/Or Rear Axle Oil	12,000 Miles
	Replace	M/T Fluid Oil	18,000 Miles
Driving In Water	Replace	Engine Oil	3,000 Miles or 3 Months
	Replace	Engine Oil Filter	6,000 Miles or 6 Months
	Service	Lube Prop Shaft If Equipped With Fittings	3,000 Miles
	Replace	A/T Fluid	12,000 Miles
	Replace	Front And/Or Rear Axle Oil	12,000 Miles
	Replace	M/T Fluid Oil	18,000 Miles
	Service	Lube Prop Shaft Slip Splines	Daily

(1) - Perform these services at the mileage, hours of operation, or number of months (since last time), whichever comes first.

NORMAL MAINTENANCE SERVICE SCHEDULES

CAUTION: The following service schedules refer to vehicles driven under normal operating conditions. For vehicles driven under severe conditions, additional services may be necessary. See SEVERE SERVICE REQUIREMENTS (PERFORM W/SERVICE SCHEDULES) above in this article for additional service requirements.

5,000 MILE (8,000 KM) SERVICE

5,000 MILE (8,000 KM) SERVICE

Service Or Inspect	
	Check Fluid Levels
	Inspect Coolant Hoses and Clamps
	Curb & Fast Idle Speed

7,500 MILE (12,000 KM) SERVICE

7,500 MILE (12,000 KM) SERVICE

Service Or Inspect	
	Check Fluid Levels
	Inspect Coolant Hoses and Clamps
	Inspect Brake System
	Inspect Exhaust System
	Inspect Underside of Vehicle (Bolts & Threaded Fasteners)
	Check/Lube Manual Steering Gear
	Check Drive Shaft Seals
	Lubricate Ball Joints, Steering Linkage & Suspension
	Lube Drive Shaft U-Joints and Slip Splines
	Lube Front Axle Drive Joint and Pivot Bearings (4WD)
	Rotate Tires and Adjust Air Pressure (Including Spare)
Replace	
	Engine Oil
	Oil Filter
	Rear Axle Fluid (Limited Slip)
Lubrication Specifications	
Application	Specification

Automatic Transmission	Dexron-II E ATF
Brake Master Cylinder	DOT 3 (SAE J-1703F) Brake Fluid
Engine Coolant	Alugard 340-2 & Water (50/50 Mixture)
Engine Oil (1)	
Gasoline Engine	
Temperature Range	
Above 30° F (-1°C)	SAE 20W-40 Or 20W-50 API SH/CD
Above 0° F (-18°C)	SAE 10W-30 Or 10W-40 API SH/CD
Less Than 60° F (16°C)	SAE 5W-30 API SH/CD
Drive Axles	SAE 75W-90 API GL-5
Drive Axles (Trac-Lok) (2)	SAE 80W-140 API GL-5
Drive Axles (Trailer Towing)	SAE 80W-140 API GL-5
Hydraulic Clutch	DOT 3 (SAE J-1703F) Brake Fluid
Manual Transmission	SAE 75W-90 API GL-5
Parking Brake Cable Guides	NLGI Grade 2, GC-LB
Door & Hood Hinges	Light Engine Oil
Manual Steering Box	Multi-Purpose NLGI Grade 2EP
Power Steering Pump	Power Steering Fluid
Transfer Case	Dexron-II E ATF
Brake Caliper Bushings	GE 661 or DOW 111 Silicone Grease
Caliper Slide Pins	GE 661 or DOW 111 Silicone Grease
Wheel Bearings	Multi-Purpose NLGI Grade GC-LB
Drive Shaft U-Joints	Multi-Purpose NLGI Grade 2EP
Steering Linkage (4) (5)	NLGI Grade 2, GC-LB
Ball Joints (4) (6)	NLGI Grade 2, GC-LB
Weatherstrip	Silicone Spray Lubricant
Wheel Lug Nut Torque	95 ft. lbs. (129 N.m)

- (1) - SAE 10W-30 SH/CD is preferred.
- (2) - Add 4 ozs. (118 ml) of Limited-Slip differential lubricant additive when changing fluid.
- (3) - For vehicles operating under heavy-duty towing conditions, use SAE 75W-140 Synthetic lube.
NOTE: Before using SAE 75W-140 Synthetic the old fluid must be DRAINED and FLUSHED with clean mineral based axle lubricant. Then refill with new synthetic lube.
- (4) - Use low pressure grease gun to prevent seal damage.
- (5) - Fill until lubricant squeezes out from the base of seals.
- (6) - Fill ball joint until seal starts to swell.

Fluid Capacities

Application	(1) Quantity
Automatic Transmission	
1984-86 (904 HD)	
Fluid Change	4.0 Qts. (3.8L)
Overhaul (Dry Fill)	8.0 Qts. (7.6L)
1987-88	
Fluid Change	4.0 Qts. (3.8L)
Overhaul (Dry Fill)	8.5 Qts. (8.0L)
Cooling System (2)	
4-Cylinder	10.0 Qts. (9.5L)
6-Cylinder	12.0 Qts. (11.4L)
Engine Oil	
4-Cylinder	4.0 Qts. (3.8L)
6-Cylinder	6.0 Qts. (5.7L)
Fuel Tank	
Standard	13.5 Gals. (51.1L)
Optional	20 Gals. (75.7L)
Manual Transmission (3)	
AX4 (AISIN)	7.4 Pts. (3.5L)
T4 (Borg-Warner)	3.9 Pts. (1.8L)

AX5 (AISIN)	7.0 Pts. (3.3L)
T5 (Borg-Warner)	4.5 Pts. (2.1L)
Transfer Case	
1985-86	
Selec-Trac (229 Full-Time)	6.0 Pts. (2.8L)
Command-Trac (Part-Time 207)	4.5 Pts. (2.1L)
1987	
Selec-Trac	2.5 Pts. (1.2L)
Command-Trac	2.2 Pts. (1.0L)
1988	
Selec-Trac	3.0 Pts. (1.4L)
Command-Trac	2.2 Pts. (1.0L)
Drive Axles (3)	
Front	2.5 Pts. (1.2L)
Front (Disconnect Housing)	5.0 Ozs. (0.15L)
Rear	2.5 Pts. (1.2L)
Rear (Trac-Lok) (4)	2.5 Pts. (1.2L)

- (1) - Capacities are recommended or calculated levels. Always use dipstick (if available) to measure level.
- (2) - Includes 2.3 qts. for coolant recovery bottle.
- (3) - Fill to bottom of filler plug hole.
- (4) - Add 4 ozs. (118 ml) of Limited-Slip differential lubricant additive first, then add new fluid.

15,000 MILE (24,000 KM) SERVICE

15,000 MILE (24,000 KM) SERVICE

Service Or Inspect	
	Verify Last Major Service Was Performed
	Check Fluid Levels
	Check Cooling System Hoses and Clamps
	Check Coolant Strength
	Check Exhaust System & Heat Shielding
	Clean Battery and Battery Terminals
	Accessory Drive Belts
	Inspect Brake System
	Inspect C/V Joint boots (4WD)
	Inspect Underside of Vehicle (Bolts & Threaded Fasteners)
	Check/Lube Manual Steering Gear
	Check Drive Shaft Seals
	Lubricate Ball Joints, Steering Linkage & Suspension
	Lube Drive Shaft U-Joints and Slip Splines
	Lube Front Axle Drive Joint and Pivot Bearings (4WD)

Inspect Front Wheel Bearings (4WD)
Check Operation of Horn, Wipers/Washers & All Exterior Lights
Inspect Condition of Wiper Blades
Check Headlight Alignment
Check Seat Belt Webbing and Release Mechanisms
Check Parking Brake Operation
Check Shift/Clutch Interlock Operation
Lubricate Weatherstripping with Silicone
Lubricate Door Hinges
Lubricate Door Locks
Check Body Drain Holes
Rotate Tires and Adjust Air Pressure
Replace
Engine Oil
Oil Filter
Automatic Transmission Fluid, Filter and Adjust Bands
Lubrication Specifications

Application	Specification
Automatic Transmission	Dexron-II E ATF
Brake Master Cylinder	DOT 3 (SAE J-1703F) Brake Fluid
Engine Coolant	Alugard 340-2 & Water (50/50 Mixture)
Engine Oil (1)	
Gasoline Engine	
Temperature Range	
Above 30° F (-1°C)	SAE 20W-40 Or 20W-50 API SH/CD
Above 0° F (-18°C)	SAE 10W-30 Or 10W-40 API SH/CD
Less Than 60° F (16°C)	SAE 5W-30 API SH/CD
Drive Axles	SAE 75W-90 API GL-5
Drive Axles (Trac-Lok) (2)	SAE 80W-140 API GL-5
Drive Axles (Trailer Towing)	SAE 80W-140 API GL-5
Hydraulic Clutch	DOT 3 (SAE J-1703F) Brake Fluid
Manual Transmission	SAE 75W-90 API GL-5
Parking Brake Cable Guides	NLGI Grade 2, GC-LB
Door & Hood Hinges	Light Engine Oil
Manual Steering Box	Multi-Purpose NLGI Grade 2EP
Power Steering Pump	Power Steering Fluid
Transfer Case	Dexron-II E ATF
Brake Caliper Bushings	GE 661 or DOW 111 Silicone Grease
Caliper Slide Pins	GE 661 or DOW 111 Silicone Grease
Wheel Bearings	Multi-Purpose NLGI Grade GC-LB
Drive Shaft U-Joints	Multi-Purpose NLGI Grade 2EP
Steering Linkage (4) (5)	NLGI Grade 2, GC-LB
Ball Joints (4) (6)	NLGI Grade 2, GC-LB
Weatherstrip	Silicone Spray Lubricant
Wheel Lug Nut Torque	95 ft. lbs. (129 N.m)

- (1) - SAE 10W-30 SH/CD is preferred.
- (2) - Add 4 ozs. (118 ml) of Limited-Slip differential lubricant additive when changing fluid.
- (3) - For vehicles operating under heavy-duty towing conditions, use SAE 75W-140 Synthetic lube.
NOTE: Before using SAE 75W-140 Synthetic the old fluid must be DRAINED and FLUSHED with clean mineral based axle lubricant. Then refill with new synthetic lube.
- (4) - Use low pressure grease gun to prevent seal damage.
- (5) - Fill until lubricant squeezes out from the base of seals.
- (6) - Fill ball joint until seal starts to swell.

Fluid Capacities

Application	(1) Quantity
Automatic Transmission	
1984-86 (904 HD)	
Fluid Change	4.0 Qts. (3.8L)
Overhaul (Dry Fill)	8.0 Qts. (7.6L)
1987-88	
Fluid Change	4.0 Qts. (3.8L)
Overhaul (Dry Fill)	8.5 Qts. (8.0L)
Cooling System (2)	
4-Cylinder	10.0 Qts. (9.5L)
6-Cylinder	12.0 Qts. (11.4L)
Engine Oil	
4-Cylinder	4.0 Qts. (3.8L)
6-Cylinder	6.0 Qts. (5.7L)
Fuel Tank	
Standard	13.5 Gals. (51.1L)
Optional	20 Gals. (75.7L)
Manual Transmission (3)	
AX4 (AISIN)	7.4 Pts. (3.5L)
T4 (Borg-Warner)	3.9 Pts. (1.8L)
AX5 (AISIN)	7.0 Pts. (3.3L)
T5 (Borg-Warner)	4.5 Pts. (2.1L)
Transfer Case	
1985-86	
Selec-Trac (229 Full-Time)	6.0 Pts. (2.8L)
Command-Trac (Part-Time 207)	4.5 Pts. (2.1L)
1987	
Selec-Trac	2.5 Pts. (1.2L)
Command-Trac	2.2 Pts. (1.0L)
1988	
Selec-Trac	3.0 Pts. (1.4L)
Command-Trac	2.2 Pts. (1.0L)
Drive Axles (3)	
Front	2.5 Pts. (1.2L)
Front (Disconnect Housing)	5.0 Ozs. (0.15L)
Rear	2.5 Pts. (1.2L)
Rear (Trac-Lok) (4)	2.5 Pts. (1.2L)

- (1) - Capacities are recommended or calculated levels. Always use dipstick (if available) to measure level.
- (2) - Includes 2.3 qts. for coolant recovery bottle.
- (3) - Fill to bottom of filler plug hole.
- (4) - Add 4 ozs. (118 ml) of Limited-Slip differential lubricant additive first, then add new fluid.

22,500 MILE (36,000 KM) SERVICE

22,500 MILE (36,000 KM) SERVICE

Service Or Inspect	
	Verify Last Major Service Was Performed
	Check Fluid Levels
	Check Fuel Lines, Connections and Valves (CNG Models)
	Check Cooling System Hoses and Clamps
	Check Exhaust System & Heat Shielding
	Lube Parking Brake Ratio Lever Pivot
	Lube Manual Gearshift Control (4WD Transfer Case)
	Inspect C/V Joint boots (4WD)
	Inspect Underside of Vehicle (Bolts & Threaded Fasteners)
	Check/Lube Manual Steering Gear
	Check Drive Shaft Seals
	Lubricate Ball Joints, Steering Linkage & Suspension
	Lube Drive Shaft U-Joints and Slip Splines
	Lube Front Axle Drive Joint and Pivot Bearings (4WD)
	Inspect/Repack Front Wheel Bearings (2WD Models)
	Inspect Front Brake Pads & Rotors
	Lubricate Caliper Slide Rails
	Inspect Rear Brake Linings & Drums
	Inspect Brake System Hoses & Lines
	Inspect Shocks for Leakage
	Inspect Tire Wear Pattern
	Rotate Tires and Adjust Air Pressure (Including Spare)
Replace	
	Engine Oil
	Oil Filter
Lubrication Specifications	
Application	Specification
Automatic Transmission	Dexron-II E ATF
Brake Master Cylinder	DOT 3 (SAE J-1703F) Brake Fluid

Engine Coolant	Alugard 340-2 & Water (50/50 Mixture)
Engine Oil (1)	
Gasoline Engine	
Temperature Range	
Above 30° F (-1°C)	SAE 20W-40 Or 20W-50 API SH/CD
Above 0° F (-18°C)	SAE 10W-30 Or 10W-40 API SH/CD
Less Than 60° F (16°C)	SAE 5W-30 API SH/CD
Drive Axles	SAE 75W-90 API GL-5
Drive Axles (Trac-Lok) (2)	SAE 80W-140 API GL-5
Drive Axles (Trailer Towing)	SAE 80W-140 API GL-5
Hydraulic Clutch	DOT 3 (SAE J-1703F) Brake Fluid
Manual Transmission	SAE 75W-90 API GL-5
Parking Brake Cable Guides	NLGI Grade 2, GC-LB
Door & Hood Hinges	Light Engine Oil
Manual Steering Box	Multi-Purpose NLGI Grade 2EP
Power Steering Pump	Power Steering Fluid
Transfer Case	Dexron-II E ATF
Brake Caliper Bushings	GE 661 or DOW 111 Silicone Grease
Caliper Slide Pins	GE 661 or DOW 111 Silicone Grease
Wheel Bearings	Multi-Purpose NLGI Grade GC-LB
Drive Shaft U-Joints	Multi-Purpose NLGI Grade 2EP
Steering Linkage (4) (5)	NLGI Grade 2, GC-LB
Ball Joints (4) (6)	NLGI Grade 2, GC-LB
Weatherstrip	Silicone Spray Lubricant
Wheel Lug Nut Torque	95 ft. lbs. (129 N.m)

- (1) - SAE 10W-30 SH/CD is preferred.
- (2) - Add 4 ozs. (118 ml) of Limited-Slip differential lubricant additive when changing fluid.
- (3) - For vehicles operating under heavy-duty towing conditions, use SAE 75W-140 Synthetic lube.
NOTE: Before using SAE 75W-140 Synthetic the old fluid must be DRAINED and FLUSHED with clean mineral based axle lubricant. Then refill with new synthetic lube.
- (4) - Use low pressure grease gun to prevent seal damage.
- (5) - Fill until lubricant squeezes out from the base of seals.
- (6) - Fill ball joint until seal starts to swell.

Fluid Capacities

Application	(1) Quantity
Automatic Transmission	
1984-86 (904 HD)	
Fluid Change	4.0 Qts. (3.8L)
Overhaul (Dry Fill)	8.0 Qts. (7.6L)
1987-88	
Fluid Change	4.0 Qts. (3.8L)
Overhaul (Dry Fill)	8.5 Qts. (8.0L)
Cooling System (2)	
4-Cylinder	10.0 Qts. (9.5L)
6-Cylinder	12.0 Qts. (11.4L)
Engine Oil	
4-Cylinder	4.0 Qts. (3.8L)
6-Cylinder	6.0 Qts. (5.7L)
Fuel Tank	
Standard	13.5 Gals. (51.1L)
Optional	20 Gals. (75.7L)
Manual Transmission (3)	
AX4 (AISIN)	7.4 Pts. (3.5L)
T4 (Borg-Warner)	3.9 Pts. (1.8L)
AX5 (AISIN)	7.0 Pts. (3.3L)
T5 (Borg-Warner)	4.5 Pts. (2.1L)

Transfer Case		
1985-86		
Selec-Trac (229 Full-Time)	6.0 Pts. (2.8L)
Command-Trac (Part-Time 207)	4.5 Pts. (2.1L)
1987		
Selec-Trac	2.5 Pts. (1.2L)
Command-Trac	2.2 Pts. (1.0L)
1988		
Selec-Trac	3.0 Pts. (1.4L)
Command-Trac	2.2 Pts. (1.0L)
Drive Axles (3)		
Front	2.5 Pts. (1.2L)
Front (Disconnect Housing)	5.0 Ozs. (0.15L)
Rear	2.5 Pts. (1.2L)
Rear (Trac-Lok) (4)	2.5 Pts. (1.2L)

- (1) - Capacities are recommended or calculated levels. Always use dipstick (if available) to measure level.
- (2) - Includes 2.3 qts. for coolant recovery bottle.
- (3) - Fill to bottom of filler plug hole.
- (4) - Add 4 ozs. (118 ml) of Limited-Slip differential lubricant additive first, then add new fluid.

30,000 MILE (48,000 KM) SERVICE

30,000 MILE (48,000 KM) SERVICE

Service Or Inspect
Verify Last Major Service Was Performed
Check Fluid Levels
Check Cooling System Hoses and Clamps
Check Coolant Strength
Check Exhaust System & Heat Shielding
Inspect Front Wheel Bearings (4WD)
Clean Battery and Battery Terminals
Adjust Drive Belt Tension
Accessory Drive Belts
Clean Choke Linkage
Inspect C/V Joint boots (4WD)
Inspect Underside of Vehicle (Bolts & Threaded Fasteners)
Check/Lube Manual Steering Gear
Check Drive Shaft Seals
Lubricate Ball Joints, Steering Linkage & Suspension
Lube Drive Shaft U-Joints and Slip Splines

Lube Front Axle Drive Joint and Pivot Bearings (4WD)
Suspension Bushings, Springs, Arms & Rear Jounce Bumpers
Parking Brake System
Lubricate Body Components
Inspect Shocks for Leakage
Inspect Tire Wear Pattern
Rotate Tires and Adjust Air Pressure (Including Spare)
Replace
Engine Oil
Oil Filter
Spark Plugs
Air Filter Element
PCV Filter
Fuel Filter

Lubrication Specifications

Application	Specification
Automatic Transmission	Dexron-II E ATF
Brake Master Cylinder	DOT 3 (SAE J-1703F) Brake Fluid
Engine Coolant	Alugard 340-2 & Water (50/50 Mixture)
Engine Oil (1)	
Gasoline Engine	
Temperature Range	
Above 30° F (-1°C)	SAE 20W-40 Or 20W-50 API SH/CD
Above 0° F (-18°C)	SAE 10W-30 Or 10W-40 API SH/CD
Less Than 60° F (16°C)	SAE 5W-30 API SH/CD
Drive Axles	SAE 75W-90 API GL-5
Drive Axles (Trac-Lok) (2)	SAE 80W-140 API GL-5
Drive Axles (Trailer Towing)	SAE 80W-140 API GL-5
Hydraulic Clutch	DOT 3 (SAE J-1703F) Brake Fluid
Manual Transmission	SAE 75W-90 API GL-5
Parking Brake Cable Guides	NLGI Grade 2, GC-LB
Door & Hood Hinges	Light Engine Oil
Manual Steering Box	Multi-Purpose NLGI Grade 2EP
Power Steering Pump	Power Steering Fluid
Transfer Case	Dexron-II E ATF
Brake Caliper Bushings	GE 661 or DOW 111 Silicone Grease
Caliper Slide Pins	GE 661 or DOW 111 Silicone Grease
Wheel Bearings	Multi-Purpose NLGI Grade GC-LB
Drive Shaft U-Joints	Multi-Purpose NLGI Grade 2EP
Steering Linkage (4) (5)	NLGI Grade 2, GC-LB
Ball Joints (4) (6)	NLGI Grade 2, GC-LB
Weatherstrip	Silicone Spray Lubricant
Wheel Lug Nut Torque	95 ft. lbs. (129 N.m)

(1) - SAE 10W-30 SH/CD is preferred.

(2) - Add 4 ozs. (118 ml) of Limited-Slip differential lubricant additive when changing fluid.

- (3) - For vehicles operating under heavy-duty towing conditions, use SAE 75W-140 Synthetic lube.
NOTE: Before using SAE 75W-140 Synthetic the old fluid must be DRAINED and FLUSHED with clean mineral based axle lubricant. Then refill with new synthetic lube.
- (4) - Use low pressure grease gun to prevent seal damage.
- (5) - Fill until lubricant squeezes out from the base of seals.
- (6) - Fill ball joint until seal starts to swell.

Fluid Capacities

Application	(1) Quantity
Automatic Transmission	
1984-86 (904 HD)	
Fluid Change	4.0 Qts. (3.8L)
Overhaul (Dry Fill)	8.0 Qts. (7.6L)
1987-88	
Fluid Change	4.0 Qts. (3.8L)
Overhaul (Dry Fill)	8.5 Qts. (8.0L)
Cooling System (2)	
4-Cylinder	10.0 Qts. (9.5L)
6-Cylinder	12.0 Qts. (11.4L)
Engine Oil	
4-Cylinder	4.0 Qts. (3.8L)
6-Cylinder	6.0 Qts. (5.7L)
Fuel Tank	
Standard	13.5 Gals. (51.1L)
Optional	20 Gals. (75.7L)
Manual Transmission (3)	
AX4 (AISIN)	7.4 Pts. (3.5L)
T4 (Borg-Warner)	3.9 Pts. (1.8L)
AX5 (AISIN)	7.0 Pts. (3.3L)
T5 (Borg-Warner)	4.5 Pts. (2.1L)
Transfer Case	
1985-86	
Selec-Trac (229 Full-Time)	6.0 Pts. (2.8L)
Command-Trac (Part-Time 207)	4.5 Pts. (2.1L)
1987	
Selec-Trac	2.5 Pts. (1.2L)
Command-Trac	2.2 Pts. (1.0L)
1988	
Selec-Trac	3.0 Pts. (1.4L)
Command-Trac	2.2 Pts. (1.0L)
Drive Axles (3)	
Front	2.5 Pts. (1.2L)
Front (Disconnect Housing)	5.0 Ozs. (0.15L)
Rear	2.5 Pts. (1.2L)
Rear (Trac-Lok) (4)	2.5 Pts. (1.2L)

- (1) - Capacities are recommended or calculated levels. Always use dipstick (if available) to measure level.
- (2) - Includes 2.3 qts. for coolant recovery bottle.
- (3) - Fill to bottom of filler plug hole.
- (4) - Add 4 ozs. (118 ml) of Limited-Slip differential lubricant additive first, then add new fluid.

Service Labor Times

Application	(1) Hours
2.5L	
Automatic Transmission	5.6

Manual Transmission	4.9
2.8L	
Automatic Transmission	5.8
Manual Transmission	5.1
4.0L	
Automatic Transmission	5.7
Manual Transmission	5.0
(1) - Add .8 hr. for vehicles equipped with 4WD.	

37,500 MILE (60,000 KM) SERVICE

37,500 MILE (60,000 KM) SERVICE

Service Or Inspect	
	Verify Last Major Service Was Performed
	Check Fluid Levels
	Check Fuel Lines, Connections
	Check Cooling System Hoses and Clamps
	Check Exhaust System & Heat Shielding
	Inspect Brake System
	Inspect C/V Joint boots (4WD)
	Inspect Underside of Vehicle (Bolts & Threaded Fasteners)
	Check/Lube Manual Steering Gear
	Check Drive Shaft Seals
	Lubricate Ball Joints, Steering Linkage & Suspension
	Lube Drive Shaft U-Joints and Slip Splines
	Lube Front Axle Drive Joint and Pivot Bearings (4WD)
	Rotate Tires and Adjust Air Pressure (Including Spare)
Replace	
	Engine Oil
	Oil Filter, if it has not been changed in the last 12 months
	Manual Transmission Fluid
	Automatic Transmission Fluid, Filter and Adjust Bands
	Transfer Case Fluid
Lubrication Specifications	
Application	Specification
Automatic Transmission	Dexron-II ATF

Brake Master Cylinder DOT 3 (SAE J-1703F) Brake Fluid
 Engine Coolant Alugard 340-2 & Water (50/50 Mixture)
 Engine Oil (1)
 Gasoline Engine
 Temperature Range
 Above 30° F (-1°C) SAE 20W-40 Or 20W-50 API SH/CD
 Above 0° F (-18°C) SAE 10W-30 Or 10W-40 API SH/CD
 Less Than 60° F (16°C) SAE 5W-30 API SH/CD
 Drive Axles SAE 75W-90 API GL-5
 Drive Axles (Trac-Lok) (2) SAE 80W-140 API GL-5
 Drive Axles (Trailer Towing) SAE 80W-140 API GL-5
 Hydraulic Clutch DOT 3 (SAE J-1703F) Brake Fluid
 Manual Transmission SAE 75W-90 API GL-5
 Parking Brake Cable Guides NLGI Grade 2, GC-LB
 Door & Hood Hinges Light Engine Oil
 Manual Steering Box Multi-Purpose NLGI Grade 2EP
 Power Steering Pump Power Steering Fluid
 Transfer Case Dexron-III ATF
 Brake Caliper Bushings GE 661 or DOW 111 Silicone Grease
 Caliper Slide Pins GE 661 or DOW 111 Silicone Grease
 Wheel Bearings Multi-Purpose NLGI Grade GC-LB
 Drive Shaft U-Joints Multi-Purpose NLGI Grade 2EP
 Steering Linkage (4) (5) NLGI Grade 2, GC-LB
 Ball Joints (4) (6) NLGI Grade 2, GC-LB
 Weatherstrip Silicone Spray Lubricant
 Wheel Lug Nut Torque 95 ft. lbs. (129 N.m)

- (1) - SAE 10W-30 SH/CD is preferred.
- (2) - Add 4 ozs. (118 ml) of Limited-Slip differential lubricant additive when changing fluid.
- (3) - For vehicles operating under heavy-duty towing conditions, use SAE 75W-140 Synthetic lube.
 NOTE: Before using SAE 75W-140 Synthetic the old fluid must be DRAINED and FLUSHED with clean mineral based axle lubricant. Then refill with new synthetic lube.
- (4) - Use low pressure grease gun to prevent seal damage.
- (5) - Fill until lubricant squeezes out from the base of seals.
- (6) - Fill ball joint until seal starts to swell.

Fluid Capacities

Application	(1) Quantity
Automatic Transmission	
1984-86 (904 HD)	
Fluid Change	4.0 Qts. (3.8L)
Overhaul (Dry Fill)	8.0 Qts. (7.6L)
1987-88	
Fluid Change	4.0 Qts. (3.8L)
Overhaul (Dry Fill)	8.5 Qts. (8.0L)
Cooling System (2)	
4-Cylinder	10.0 Qts. (9.5L)
6-Cylinder	12.0 Qts. (11.4L)
Engine Oil	
4-Cylinder	4.0 Qts. (3.8L)
6-Cylinder	6.0 Qts. (5.7L)
Fuel Tank	
Standard	13.5 Gals. (51.1L)
Optional	20 Gals. (75.7L)
Manual Transmission (3)	
AX4 (AISIN)	7.4 Pts. (3.5L)
T4 (Borg-Warner)	3.9 Pts. (1.8L)
AX5 (AISIN)	7.0 Pts. (3.3L)

T5 (Borg-Warner)	4.5 Pts. (2.1L)
Transfer Case	
1985-86	
Selec-Trac (229 Full-Time)	6.0 Pts. (2.8L)
Command-Trac (Part-Time 207)	4.5 Pts. (2.1L)
1987	
Selec-Trac	2.5 Pts. (1.2L)
Command-Trac	2.2 Pts. (1.0L)
1988	
Selec-Trac	3.0 Pts. (1.4L)
Command-Trac	2.2 Pts. (1.0L)
Drive Axles (3)	
Front	2.5 Pts. (1.2L)
Front (Disconnect Housing)	5.0 Ozs. (0.15L)
Rear	2.5 Pts. (1.2L)
Rear (Trac-Lok) (4)	2.5 Pts. (1.2L)

- (1) - Capacities are recommended or calculated levels. Always use dipstick (if available) to measure level.
- (2) - Includes 2.3 qts. for coolant recovery bottle.
- (3) - Fill to bottom of filler plug hole.
- (4) - Add 4 ozs. (118 ml) of Limited-Slip differential lubricant additive first, then add new fluid.

45,000 MILE (72,000 KM) SERVICE

45,000 MILE (72,000 KM) SERVICE

Service Or Inspect
Verify Last Major Service Was Performed
Check Fluid Levels
Check Fuel Lines, Connections
Check Cooling System Hoses and Clamps
Check Coolant Strength
Clean Battery and Battery Terminals
Accessory Drive Belts
Check Exhaust System & Heat Shielding
Check Operation of Horn, Wipers/Washers & All Exterior Lights
Inspect Condition of Wiper Blades
Check Headlight Alignment
Check Seat Belt Webbing and Release Mechanisms
Check Parking Brake Operation
Check Shift/Clutch Interlock Operation
Inspect C/V Joint boots (4WD)
Inspect Underside of Vehicle (Bolts & Threaded Fasteners)

Check/Lube Manual Steering Gear
Check Drive Shaft Seals
Lubricate Ball Joints, Steering Linkage & Suspension
Lube Drive Shaft U-Joints and Slip Splines
Lube Front Axle Drive Joint and Pivot Bearings (4WD)
Lube Parking Brake Ratio Lever Pivot
Lube Manual Gearshift Control (4WD Transfer Case)
Inspect/Repack Front Wheel Bearings (2WD Models)
Inspect Front Brake Pads & Rotors
Lubricate Caliper Slide Rails
Inspect Rear Brake Linings & Drums
Inspect Brake System Hoses & Lines
Inspect Shocks for Leakage
Inspect Tire Wear Pattern
Lubricate Weatherstripping with Silicone
Lubricate Door Hinges
Lubricate Door Locks
Check Body Drain Holes
Rotate Tires and Adjust Air Pressure
Replace
Engine Oil
Oil Filter
Automatic Transmission Fluid, Filter and Adjust Bands
Flush and Fill Engine Coolant, if not done in last 36 months

Lubrication Specifications

Application	Specification
Automatic Transmission	Dexron-II E ATF
Brake Master Cylinder	DOT 3 (SAE J-1703F) Brake Fluid
Engine Coolant	Alugard 340-2 & Water (50/50 Mixture)
Engine Oil (1)	
Gasoline Engine	
Temperature Range	
Above 30° F (-1°C)	SAE 20W-40 Or 20W-50 API SH/CD
Above 0° F (-18°C)	SAE 10W-30 Or 10W-40 API SH/CD
Less Than 60° F (16°C)	SAE 5W-30 API SH/CD
Drive Axles	SAE 75W-90 API GL-5

Drive Axles (Trac-Lok) (2)	SAE 80W-140 API GL-5
Drive Axles (Trailer Towing)	SAE 80W-140 API GL-5
Hydraulic Clutch	DOT 3 (SAE J-1703F) Brake Fluid
Manual Transmission	SAE 75W-90 API GL-5
Parking Brake Cable Guides	NLGI Grade 2, GC-LB
Door & Hood Hinges	Light Engine Oil
Manual Steering Box	Multi-Purpose NLGI Grade 2EP
Power Steering Pump	Power Steering Fluid
Transfer Case	Dexron-II E ATF
Brake Caliper Bushings	GE 661 or DOW 111 Silicone Grease
Brake Caliper Slide Pins	GE 661 or DOW 111 Silicone Grease
Wheel Bearings	Multi-Purpose NLGI Grade GC-LB
Drive Shaft U-Joints	Multi-Purpose NLGI Grade 2EP
Steering Linkage (4)(5)	NLGI Grade 2, GC-LB
Ball Joints (4)(6)	NLGI Grade 2, GC-LB
Weatherstrip	Silicone Spray Lubricant
Wheel Lug Nut Torque	95 ft. lbs. (129 N.m)

- (1) - SAE 10W-30 SH/CD is preferred.
- (2) - Add 4 ozs. (118 ml) of Limited-Slip differential lubricant additive when changing fluid.
- (3) - For vehicles operating under heavy-duty towing conditions, use SAE 75W-140 Synthetic lube.
NOTE: Before using SAE 75W-140 Synthetic the old fluid must be DRAINED and FLUSHED with clean mineral based axle lubricant. Then refill with new synthetic lube.
- (4) - Use low pressure grease gun to prevent seal damage.
- (5) - Fill until lubricant squeezes out from the base of seals.
- (6) - Fill ball joint until seal starts to swell.

Fluid Capacities

Application	(1) Quantity
Automatic Transmission	
1984-86 (904 HD)	
Fluid Change	4.0 Qts. (3.8L)
Overhaul (Dry Fill)	8.0 Qts. (7.6L)
1987-88	
Fluid Change	4.0 Qts. (3.8L)
Overhaul (Dry Fill)	8.5 Qts. (8.0L)
Cooling System (2)	
4-Cylinder	10.0 Qts. (9.5L)
6-Cylinder	12.0 Qts. (11.4L)
Engine Oil	
4-Cylinder	4.0 Qts. (3.8L)
6-Cylinder	6.0 Qts. (5.7L)
Fuel Tank	
Standard	13.5 Gals. (51.1L)
Optional	20 Gals. (75.7L)
Manual Transmission (3)	
AX4 (AISIN)	7.4 Pts. (3.5L)
T4 (Borg-Warner)	3.9 Pts. (1.8L)
AX5 (AISIN)	7.0 Pts. (3.3L)
T5 (Borg-Warner)	4.5 Pts. (2.1L)
Transfer Case	
1985-86	
Selec-Trac (229 Full-Time)	6.0 Pts. (2.8L)
Command-Trac (Part-Time 207)	4.5 Pts. (2.1L)
1987	
Selec-Trac	2.5 Pts. (1.2L)
Command-Trac	2.2 Pts. (1.0L)
1988	

Selec-Trac	3.0 Pts. (1.4L)
Command-Trac	2.2 Pts. (1.0L)
Drive Axles (3)	
Front	2.5 Pts. (1.2L)
Front (Disconnect Housing)	5.0 Ozs. (0.15L)
Rear	2.5 Pts. (1.2L)
Rear (Trac-Lok) (4)	2.5 Pts. (1.2L)

- (1) - Capacities are recommended or calculated levels. Always use dipstick (if available) to measure level.
- (2) - Includes 2.3 qts. for coolant recovery bottle.
- (3) - Fill to bottom of filler plug hole.
- (4) - Add 4 ozs. (118 ml) of Limited-Slip differential lubricant additive first, then add new fluid.

52,500 MILE (84,000 KM) SERVICE

52,500 MILE (84,000 KM) SERVICE

Service Or Inspect
Verify Last Major Service Was Performed
Check Fluid Levels
Check Fuel Lines, Connections
Check Cooling System Hoses and Clamps
Check Exhaust System & Heat Shielding
Curb & Fast Idle Speed
Clean Choke Linkage
Ignition Timing
Inspect Brake System
Inspect C/V Joint boots (4WD)
Inspect Underside of Vehicle (Bolts & Threaded Fasteners)
Check/Lube Manual Steering Gear
Check Drive Shaft Seals
Lubricate Ball Joints, Steering Linkage & Suspension
Lube Drive Shaft U-Joints and Slip Splines
Lube Front Axle Drive Joint and Pivot Bearings (4WD)
Rotate Tires and Adjust Air Pressure (Including Spare)
Replace
Engine Oil
Oil Filter, if it has not been changed in the last 12 months

Flush and Fill Engine Coolant, if not done in last 36 months

Lubrication Specifications

Application	Specification
Automatic Transmission	Dexron-IIe ATF
Brake Master Cylinder	DOT 3 (SAE J-1703F) Brake Fluid
Engine Coolant	Alugard 340-2 & Water (50/50 Mixture)
Engine Oil (1)	
Gasoline Engine	
Temperature Range	
Above 30° F (-1°C)	SAE 20W-40 Or 20W-50 API SH/CD
Above 0° F (-18°C)	SAE 10W-30 Or 10W-40 API SH/CD
Less Than 60° F (16°C)	SAE 5W-30 API SH/CD
Drive Axles	SAE 75W-90 API GL-5
Drive Axles (Trac-Lok) (2)	SAE 80W-140 API GL-5
Drive Axles (Trailer Towing)	SAE 80W-140 API GL-5
Hydraulic Clutch	DOT 3 (SAE J-1703F) Brake Fluid
Manual Transmission	SAE 75W-90 API GL-5
Parking Brake Cable Guides	NLGI Grade 2, GC-LB
Door & Hood Hinges	Light Engine Oil
Manual Steering Box	Multi-Purpose NLGI Grade 2EP
Power Steering Pump	Power Steering Fluid
Transfer Case	Dexron-IIe ATF
Brake Caliper Bushings	GE 661 or DOW 111 Silicone Grease
Caliper Slide Pins	GE 661 or DOW 111 Silicone Grease
Wheel Bearings	Multi-Purpose NLGI Grade GC-LB
Drive Shaft U-Joints	Multi-Purpose NLGI Grade 2EP
Steering Linkage (4) (5)	NLGI Grade 2, GC-LB
Ball Joints (4) (6)	NLGI Grade 2, GC-LB
Weatherstrip	Silicone Spray Lubricant
Wheel Lug Nut Torque	95 ft. lbs. (129 N.m)

- (1) - SAE 10W-30 SH/CD is preferred.
- (2) - Add 4 ozs. (118 ml) of Limited-Slip differential lubricant additive when changing fluid.
- (3) - For vehicles operating under heavy-duty towing conditions, use SAE 75W-140 Synthetic lube.
NOTE: Before using SAE 75W-140 Synthetic the old fluid must be DRAINED and FLUSHED with clean mineral based axle lubricant. Then refill with new synthetic lube.
- (4) - Use low pressure grease gun to prevent seal damage.
- (5) - Fill until lubricant squeezes out from the base of seals.
- (6) - Fill ball joint until seal starts to swell.

Fluid Capacities

Application	(1) Quantity
Automatic Transmission	
1984-86 (904 HD)	
Fluid Change	4.0 Qts. (3.8L)
Overhaul (Dry Fill)	8.0 Qts. (7.6L)
1987-88	
Fluid Change	4.0 Qts. (3.8L)
Overhaul (Dry Fill)	8.5 Qts. (8.0L)
Cooling System (2)	
4-Cylinder	10.0 Qts. (9.5L)
6-Cylinder	12.0 Qts. (11.4L)
Engine Oil	
4-Cylinder	4.0 Qts. (3.8L)
6-Cylinder	6.0 Qts. (5.7L)

Fuel Tank	
Standard	13.5 Gals. (51.1L)
Optional	20 Gals. (75.7L)
Manual Transmission (3)	
AX4 (AISIN)	7.4 Pts. (3.5L)
T4 (Borg-Warner)	3.9 Pts. (1.8L)
AX5 (AISIN)	7.0 Pts. (3.3L)
T5 (Borg-Warner)	4.5 Pts. (2.1L)
Transfer Case	
1985-86	
Selec-Trac (229 Full-Time)	6.0 Pts. (2.8L)
Command-Trac (Part-Time 207)	4.5 Pts. (2.1L)
1987	
Selec-Trac	2.5 Pts. (1.2L)
Command-Trac	2.2 Pts. (1.0L)
1988	
Selec-Trac	3.0 Pts. (1.4L)
Command-Trac	2.2 Pts. (1.0L)
Drive Axles (3)	
Front	2.5 Pts. (1.2L)
Front (Disconnect Housing)	5.0 Ozs. (0.15L)
Rear	2.5 Pts. (1.2L)
Rear (Trac-Lok) (4)	2.5 Pts. (1.2L)

- (1) - Capacities are recommended or calculated levels. Always use dipstick (if available) to measure level.
- (2) - Includes 2.3 qts. for coolant recovery bottle.
- (3) - Fill to bottom of filler plug hole.
- (4) - Add 4 ozs. (118 ml) of Limited-Slip differential lubricant additive first, then add new fluid.

60,000 MILE (96,000 KM) SERVICE

60,000 MILE (96,000 KM) SERVICE

Service Or Inspect
Verify Last Major Service Was Performed
Check Fluid Levels
Check Cooling System Hoses and Clamps
Check Coolant Strength
Check Accessory Drive Belts
Check Exhaust System & Heat Shielding
Clean Battery and Battery Terminals
Clean and Lubricate Crankcase Inlet Air Cleaner
Inspect Brake System
Inspect Exhaust System
Adjust Drive Belt Tension
Adjust Idle - Propane Method (1987-88 Carbureted Only)

Choke Linkage
Ignition Timing
Lubricate Manifold Heat Control Valve (if equipped)
Clean PCV Breather (if equipped)
Clean EGR Passages (if equipped)
Inspect C/V Joint boots (4WD)
Inspect Underside of Vehicle (Bolts & Threaded Fasteners)
Check/Lube Manual Steering Gear
Check Drive Shaft Seals
Lubricate Ball Joints, Steering Linkage & Suspension
Lube Drive Shaft U-Joints and Slip Splines
Lube Front Axle Drive Joint and Pivot Bearings (4WD)
Inspect Front Wheel Bearings (4WD)
Suspension Bushings, Springs, Arms & Rear Jounce Bumpers
Parking Brake System
Inspect Shocks for Leakage
Inspect Tire Wear Pattern
Rotate Tires and Adjust Air Pressure (Including Spare)
Replace
Engine Oil
Oil Filter
Spark Plugs
Ignition Cables
Distributor Cap and Rotor
Air Filter Element
EGR Valve & Tube (1987-92)
Vacuum Operated Emission Components (1987-92)
PCV Valve (1)
Drive Belt (V-Type) (2)
Flush and Fill Engine Coolant, if not done in last 24 months
Automatic Transmission Fluid, Filter and Adjust Bands
Accessory Drive Belts

Fuel Filter
Emission System Vacuum Hoses
Ignition Wires
Distributor Cap & Rotor
Battery

- (1) - Replacement is recommended by Chrysler at this time, but it is not required to maintain the warranty on the PCV valve.
- (2) - Check and replace as needed.

Lubrication Specifications

Application	Specification
Automatic Transmission	Dexron-II ATF
Brake Master Cylinder	DOT 3 (SAE J-1703F) Brake Fluid
Engine Coolant	Alugard 340-2 & Water (50/50 Mixture)
Engine Oil (1)	
Gasoline Engine	
Temperature Range	
Above 30° F (-1°C)	SAE 20W-40 Or 20W-50 API SH/CD
Above 0° F (-18°C)	SAE 10W-30 Or 10W-40 API SH/CD
Less Than 60° F (16°C)	SAE 5W-30 API SH/CD
Drive Axles	SAE 75W-90 API GL-5
Drive Axles (Trac-Lok) (2)	SAE 80W-140 API GL-5
Drive Axles (Trailer Towing)	SAE 80W-140 API GL-5
Hydraulic Clutch	DOT 3 (SAE J-1703F) Brake Fluid
Manual Transmission	SAE 75W-90 API GL-5
Parking Brake Cable Guides	NLGI Grade 2, GC-LB
Door & Hood Hinges	Light Engine Oil
Manual Steering Box	Multi-Purpose NLGI Grade 2EP
Power Steering Pump	Power Steering Fluid
Transfer Case	Dexron-II ATF
Brake Caliper Bushings	GE 661 or DOW 111 Silicone Grease
Caliper Slide Pins	GE 661 or DOW 111 Silicone Grease
Wheel Bearings	Multi-Purpose NLGI Grade GC-LB
Drive Shaft U-Joints	Multi-Purpose NLGI Grade 2EP
Steering Linkage (4)(5)	NLGI Grade 2, GC-LB
Ball Joints (4)(6)	NLGI Grade 2, GC-LB
Weatherstrip	Silicone Spray Lubricant
Wheel Lug Nut Torque	95 ft. lbs. (129 N.m)

- (1) - SAE 10W-30 SH/CD is preferred.
- (2) - Add 4 ozs. (118 ml) of Limited-Slip differential lubricant additive when changing fluid.
- (3) - For vehicles operating under heavy-duty towing conditions, use SAE 75W-140 Synthetic lube.
NOTE: Before using SAE 75W-140 Synthetic the old fluid must be DRAINED and FLUSHED with clean mineral based axle lubricant. Then refill with new synthetic lube.
- (4) - Use low pressure grease gun to prevent seal damage.
- (5) - Fill until lubricant squeezes out from the base of seals.
- (6) - Fill ball joint until seal starts to swell.

Fluid Capacities

Application	(1) Quantity
-------------	--------------

Automatic Transmission	
1984-86 (904 HD)	
Fluid Change	4.0 Qts. (3.8L)
Overhaul (Dry Fill)	8.0 Qts. (7.6L)
1987-88	
Fluid Change	4.0 Qts. (3.8L)
Overhaul (Dry Fill)	8.5 Qts. (8.0L)
Cooling System (2)	
4-Cylinder	10.0 Qts. (9.5L)
6-Cylinder	12.0 Qts. (11.4L)
Engine Oil	
4-Cylinder	4.0 Qts. (3.8L)
6-Cylinder	6.0 Qts. (5.7L)
Fuel Tank	
Standard	13.5 Gals. (51.1L)
Optional	20 Gals. (75.7L)
Manual Transmission (3)	
AX4 (AISIN)	7.4 Pts. (3.5L)
T4 (Borg-Warner)	3.9 Pts. (1.8L)
AX5 (AISIN)	7.0 Pts. (3.3L)
T5 (Borg-Warner)	4.5 Pts. (2.1L)
Transfer Case	
1985-86	
Selec-Trac (229 Full-Time)	6.0 Pts. (2.8L)
Command-Trac (Part-Time 207)	4.5 Pts. (2.1L)
1987	
Selec-Trac	2.5 Pts. (1.2L)
Command-Trac	2.2 Pts. (1.0L)
1988	
Selec-Trac	3.0 Pts. (1.4L)
Command-Trac	2.2 Pts. (1.0L)
Drive Axles (3)	
Front	2.5 Pts. (1.2L)
Front (Disconnect Housing)	5.0 Ozs. (0.15L)
Rear	2.5 Pts. (1.2L)
Rear (Trac-Lok) (4)	2.5 Pts. (1.2L)

- (1) - Capacities are recommended or calculated levels. Always use dipstick (if available) to measure level.
(2) - Includes 2.3 qts. for coolant recovery bottle.
(3) - Fill to bottom of filler plug hole.
(4) - Add 4 ozs. (118 ml) of Limited-Slip differential lubricant additive first, then add new fluid.

Service Labor Times

Application	Hours
2.5L	
Automatic Transmission	3.5
Manual Transmission	3.5
2.8L	
Automatic Transmission	3.7
Manual Transmission	3.7
4.0L	
Automatic Transmission	3.6
Manual Transmission	3.6

67,500 MILE (108,000 KM) SERVICE

67,500 MILE (108,000 KM) SERVICE

Service Or Inspect	
	Verify Last Major Service Was Performed
	Check Fluid Levels
	Check Fuel Lines, Connections
	Check Cooling System Hoses and Clamps
	Check Exhaust System & Heat Shielding
	Inspect C/V Joint boots (4WD)
	Inspect Underside of Vehicle (Bolts & Threaded Fasteners)
	Check/Lube Manual Steering Gear
	Check Drive Shaft Seals
	Lubricate Ball Joints, Steering Linkage & Suspension
	Lube Drive Shaft U-Joints and Slip Splines
	Lube Front Axle Drive Joint and Pivot Bearings (4WD)
	Lube Parking Brake Ratio Lever Pivot
	Lube Manual Gearshift Control (4WD Transfer Case)
	Inspect/Repack Front Wheel Bearings (2WD Models)
	Inspect Front Brake Pads & Rotors
	Lubricate Caliper Slide Rails
	Inspect Rear Brake Linings & Drums
	Inspect Brake System Hoses & Lines
	Inspect Shocks for Leakage
	Inspect Tire Wear Pattern
	Rotate Tires and Adjust Air Pressure (Including Spare)
Replace	
	Engine Oil
	Oil Filter, if it has not been changed in the last 12 months
Lubrication Specifications	
Application	Specification
Automatic Transmission	Dexron-IIe ATF
Brake Master Cylinder	DOT 3 (SAE J-1703F) Brake Fluid
Engine Coolant	Alugard 340-2 & Water (50/50 Mixture)
Engine Oil (1)	
Gasoline Engine	
Temperature Range	

Above 30° F (-1°C)	SAE 20W-40 Or 20W-50 API SH/CD
Above 0° F (-18°C)	SAE 10W-30 Or 10W-40 API SH/CD
Less Than 60° F (16°C)	SAE 5W-30 API SH/CD
Drive Axles	SAE 75W-90 API GL-5
Drive Axles (Trac-Lok) (2)	SAE 80W-140 API GL-5
Drive Axles (Trailer Towing)	SAE 80W-140 API GL-5
Hydraulic Clutch	DOT 3 (SAE J-1703F) Brake Fluid
Manual Transmission	SAE 75W-90 API GL-5
Parking Brake Cable Guides	NLGI Grade 2, GC-LB
Door & Hood Hinges	Light Engine Oil
Manual Steering Box	Multi-Purpose NLGI Grade 2EP
Power Steering Pump	Power Steering Fluid
Transfer Case	Dexron-II E ATF
Brake Caliper Bushings	GE 661 or DOW 111 Silicone Grease
Caliper Slide Pins	GE 661 or DOW 111 Silicone Grease
Wheel Bearings	Multi-Purpose NLGI Grade GC-LB
Drive Shaft U-Joints	Multi-Purpose NLGI Grade 2EP
Steering Linkage (4) (5)	NLGI Grade 2, GC-LB
Ball Joints (4) (6)	NLGI Grade 2, GC-LB
Weatherstrip	Silicone Spray Lubricant
Wheel Lug Nut Torque	95 ft. lbs. (129 N.m)

- (1) - SAE 10W-30 SH/CD is preferred.
- (2) - Add 4 ozs. (118 ml) of Limited-Slip differential lubricant additive when changing fluid.
- (3) - For vehicles operating under heavy-duty towing conditions, use SAE 75W-140 Synthetic lube.
NOTE: Before using SAE 75W-140 Synthetic the old fluid must be DRAINED and FLUSHED with clean mineral based axle lubricant. Then refill with new synthetic lube.
- (4) - Use low pressure grease gun to prevent seal damage.
- (5) - Fill until lubricant squeezes out from the base of seals.
- (6) - Fill ball joint until seal starts to swell.

Fluid Capacities

Application	(1) Quantity
Automatic Transmission	
1984-86 (904 HD)	
Fluid Change	4.0 Qts. (3.8L)
Overhaul (Dry Fill)	8.0 Qts. (7.6L)
1987-88	
Fluid Change	4.0 Qts. (3.8L)
Overhaul (Dry Fill)	8.5 Qts. (8.0L)
Cooling System (2)	
4-Cylinder	10.0 Qts. (9.5L)
6-Cylinder	12.0 Qts. (11.4L)
Engine Oil	
4-Cylinder	4.0 Qts. (3.8L)
6-Cylinder	6.0 Qts. (5.7L)
Fuel Tank	
Standard	13.5 Gals. (51.1L)
Optional	20 Gals. (75.7L)
Manual Transmission (3)	
AX4 (AISIN)	7.4 Pts. (3.5L)
T4 (Borg-Warner)	3.9 Pts. (1.8L)
AX5 (AISIN)	7.0 Pts. (3.3L)
T5 (Borg-Warner)	4.5 Pts. (2.1L)
Transfer Case	
1985-86	
Selec-Trac (229 Full-Time)	6.0 Pts. (2.8L)
Command-Trac (Part-Time 207)	4.5 Pts. (2.1L)

1987		
Selec-Trac	2.5 Pts. (1.2L)
Command-Trac	2.2 Pts. (1.0L)
1988		
Selec-Trac	3.0 Pts. (1.4L)
Command-Trac	2.2 Pts. (1.0L)
Drive Axles (3)		
Front	2.5 Pts. (1.2L)
Front (Disconnect Housing)	5.0 Ozs. (0.15L)
Rear	2.5 Pts. (1.2L)
Rear (Trac-Lok) (4)	2.5 Pts. (1.2L)
(1) - Capacities are recommended or calculated levels. Always use dipstick (if available) to measure level.		
(2) - Includes 2.3 qts. for coolant recovery bottle.		
(3) - Fill to bottom of filler plug hole.		
(4) - Add 4 ozs. (118 ml) of Limited-Slip differential lubricant additive first, then add new fluid.		

75,000 MILE (120,000 KM) SERVICE

75,000 MILE (120,000 KM) SERVICE

Service Or Inspect	
	Verify Last Major Service Was Performed
	Check Fluid Levels
	Check Fuel Lines, Connections
	Check Cooling System Hoses and Clamps
	Check Coolant Strength
	Check Exhaust System & Heat Shielding
	Clean Battery and Battery Terminals
	Adjust Drive Belt Tension
	Inspect Brake System
	Check Operation of Horn, Wipers/Washers & All Exterior Lights
	Inspect Condition of Wiper Blades
	Check Headlight Alignment
	Check Seat Belt Webbing and Release Mechanisms
	Check Parking Brake Operation
	Check Shift/Clutch Interlock Operation
	Inspect C/V Joint boots (4WD)
	Inspect Underside of Vehicle (Bolts & Threaded Fasteners)
	Check/Lube Manual Steering Gear

Check Drive Shaft Seals
Lubricate Ball Joints, Steering Linkage & Suspension
Lube Drive Shaft U-Joints and Slip Splines
Lube Front Axle Drive Joint and Pivot Bearings (4WD)
Lubricate Weatherstripping with Silicone
Lubricate Door Hinges
Lubricate Door Locks
Check Body Drain Holes
Rotate Tires and Adjust Air Pressure
Replace
Engine Oil
Oil Filter
Manual Transmission Fluid
Automatic Transmission Fluid, Filter and Adjust Bands
Transfer Case Fluid
Flush and Fill Engine Coolant, if not done in last 24 months
Lubrication Specifications

Application	Specification
Automatic Transmission	Dexron-II E ATF
Brake Master Cylinder	DOT 3 (SAE J-1703F) Brake Fluid
Engine Coolant	Alugard 340-2 & Water (50/50 Mixture)
Engine Oil (1)	
Gasoline Engine	
Temperature Range	
Above 30° F (-1°C)	SAE 20W-40 Or 20W-50 API SH/CD
Above 0° F (-18°C)	SAE 10W-30 Or 10W-40 API SH/CD
Less Than 60° F (16°C)	SAE 5W-30 API SH/CD
Drive Axles	SAE 75W-90 API GL-5
Drive Axles (Trac-Lok) (2)	SAE 80W-140 API GL-5
Drive Axles (Trailer Towing)	SAE 80W-140 API GL-5
Hydraulic Clutch	DOT 3 (SAE J-1703F) Brake Fluid
Manual Transmission	SAE 75W-90 API GL-5
Parking Brake Cable Guides	NLGI Grade 2, GC-LB
Door & Hood Hinges	Light Engine Oil
Manual Steering Box	Multi-Purpose NLGI Grade 2EP
Power Steering Pump	Power Steering Fluid
Transfer Case	Dexron-II E ATF
Brake Caliper Bushings	GE 661 or DOW 111 Silicone Grease
Caliper Slide Pins	GE 661 or DOW 111 Silicone Grease
Wheel Bearings	Multi-Purpose NLGI Grade GC-LB
Drive Shaft U-Joints	Multi-Purpose NLGI Grade 2EP
Steering Linkage (4) (5)	NLGI Grade 2, GC-LB
Ball Joints (4) (6)	NLGI Grade 2, GC-LB
Weatherstrip	Silicone Spray Lubricant
Wheel Lug Nut Torque	95 ft. lbs. (129 N.m)

- (1) - SAE 10W-30 SH/CD is preferred.
- (2) - Add 4 ozs. (118 ml) of Limited-Slip differential lubricant additive when changing fluid.
- (3) - For vehicles operating under heavy-duty towing conditions, use SAE 75W-140 Synthetic lube.
NOTE: Before using SAE 75W-140 Synthetic the old fluid must be DRAINED and FLUSHED with clean mineral based axle lubricant. Then refill with new synthetic lube.
- (4) - Use low pressure grease gun to prevent seal damage.
- (5) - Fill until lubricant squeezes out from the base of seals.
- (6) - Fill ball joint until seal starts to swell.

Fluid Capacities

Application	(1) Quantity
Automatic Transmission	
1984-86 (904 HD)	
Fluid Change	4.0 Qts. (3.8L)
Overhaul (Dry Fill)	8.0 Qts. (7.6L)
1987-88	
Fluid Change	4.0 Qts. (3.8L)
Overhaul (Dry Fill)	8.5 Qts. (8.0L)
Cooling System (2)	
4-Cylinder	10.0 Qts. (9.5L)
6-Cylinder	12.0 Qts. (11.4L)
Engine Oil	
4-Cylinder	4.0 Qts. (3.8L)
6-Cylinder	6.0 Qts. (5.7L)
Fuel Tank	
Standard	13.5 Gals. (51.1L)
Optional	20 Gals. (75.7L)
Manual Transmission (3)	
AX4 (AISIN)	7.4 Pts. (3.5L)
T4 (Borg-Warner)	3.9 Pts. (1.8L)
AX5 (AISIN)	7.0 Pts. (3.3L)
T5 (Borg-Warner)	4.5 Pts. (2.1L)
Transfer Case	
1985-86	
Selec-Trac (229 Full-Time)	6.0 Pts. (2.8L)
Command-Trac (Part-Time 207)	4.5 Pts. (2.1L)
1987	
Selec-Trac	2.5 Pts. (1.2L)
Command-Trac	2.2 Pts. (1.0L)
1988	
Selec-Trac	3.0 Pts. (1.4L)
Command-Trac	2.2 Pts. (1.0L)
Drive Axles (3)	
Front	2.5 Pts. (1.2L)
Front (Disconnect Housing)	5.0 Ozs. (0.15L)
Rear	2.5 Pts. (1.2L)
Rear (Trac-Lok) (4)	2.5 Pts. (1.2L)

- (1) - Capacities are recommended or calculated levels. Always use dipstick (if available) to measure level.
- (2) - Includes 2.3 qts. for coolant recovery bottle.
- (3) - Fill to bottom of filler plug hole.
- (4) - Add 4 ozs. (118 ml) of Limited-Slip differential lubricant additive first, then add new fluid.

82,500 MILE (132,000 KM) SERVICE

82,500 MILE (132,000 KM) SERVICE

Service Or Inspect	
	Verify Last Major Service Was Performed
	Check Fluid Levels
	Check Cooling System Hoses and Clamps
	Check Exhaust System & Heat Shielding
	Inspect Brake System
	Inspect C/V Joint boots (4WD)
	Inspect Underside of Vehicle (Bolts & Threaded Fasteners)
	Check/Lube Manual Steering Gear
	Check Drive Shaft Seals
	Lubricate Ball Joints, Steering Linkage & Suspension
	Lube Drive Shaft U-Joints and Slip Splines
	Lube Front Axle Drive Joint and Pivot Bearings (4WD)
	Rotate Tires and Adjust Air Pressure (Including Spare)
Replace	
	Engine Oil
	Oil Filter, if it has not been changed in the last 12 months
	O2 Sensor (1987-89)
	Flush and Fill Engine Coolant, if not done in last 24 months
Lubrication Specifications	
Application	Specification
Automatic Transmission	Dexron-II E ATF
Brake Master Cylinder	DOT 3 (SAE J-1703F) Brake Fluid
Engine Coolant	Alugard 340-2 & Water (50/50 Mixture)
Engine Oil (1)	
Gasoline Engine	
Temperature Range	
Above 30° F (-1°C)	SAE 20W-40 Or 20W-50 API SH/CD
Above 0° F (-18°C)	SAE 10W-30 Or 10W-40 API SH/CD
Less Than 60° F (16°C)	SAE 5W-30 API SH/CD
Drive Axles	SAE 75W-90 API GL-5
Drive Axles (Trac-Lok) (2)	SAE 80W-140 API GL-5
Drive Axles (Trailer Towing)	SAE 80W-140 API GL-5
Hydraulic Clutch	DOT 3 (SAE J-1703F) Brake Fluid
Manual Transmission	SAE 75W-90 API GL-5
Parking Brake Cable Guides	NLGI Grade 2, GC-LB
Door & Hood Hinges	Light Engine Oil

Manual Steering Box Multi-Purpose NLGI Grade 2EP
 Power Steering Pump Power Steering Fluid
 Transfer Case Dexron-IIIE ATF
 Brake Caliper Bushings GE 661 or DOW 111 Silicone Grease
 Caliper Slide Pins GE 661 or DOW 111 Silicone Grease
 Wheel Bearings Multi-Purpose NLGI Grade GC-LB
 Drive Shaft U-Joints Multi-Purpose NLGI Grade 2EP
 Steering Linkage (4) (5) NLGI Grade 2, GC-LB
 Ball Joints (4) (6) NLGI Grade 2, GC-LB
 Weatherstrip Silicone Spray Lubricant
 Wheel Lug Nut Torque 95 ft. lbs. (129 N.m)

- (1) - SAE 10W-30 SH/CD is preferred.
- (2) - Add 4 ozs. (118 ml) of Limited-Slip differential lubricant additive when changing fluid.
- (3) - For vehicles operating under heavy-duty towing conditions, use SAE 75W-140 Synthetic lube.
 NOTE: Before using SAE 75W-140 Synthetic the old fluid must be DRAINED and FLUSHED with clean mineral based axle lubricant. Then refill with new synthetic lube.
- (4) - Use low pressure grease gun to prevent seal damage.
- (5) - Fill until lubricant squeezes out from the base of seals.
- (6) - Fill ball joint until seal starts to swell.

Fluid Capacities

Application	(1) Quantity
Automatic Transmission	
1984-86 (904 HD)	
Fluid Change	4.0 Qts. (3.8L)
Overhaul (Dry Fill)	8.0 Qts. (7.6L)
1987-88	
Fluid Change	4.0 Qts. (3.8L)
Overhaul (Dry Fill)	8.5 Qts. (8.0L)
Cooling System (2)	
4-Cylinder	10.0 Qts. (9.5L)
6-Cylinder	12.0 Qts. (11.4L)
Engine Oil	
4-Cylinder	4.0 Qts. (3.8L)
6-Cylinder	6.0 Qts. (5.7L)
Fuel Tank	
Standard	13.5 Gals. (51.1L)
Optional	20 Gals. (75.7L)
Manual Transmission (3)	
AX4 (AISIN)	7.4 Pts. (3.5L)
T4 (Borg-Warner)	3.9 Pts. (1.8L)
AX5 (AISIN)	7.0 Pts. (3.3L)
T5 (Borg-Warner)	4.5 Pts. (2.1L)
Transfer Case	
1985-86	
Selec-Trac (229 Full-Time)	6.0 Pts. (2.8L)
Command-Trac (Part-Time 207)	4.5 Pts. (2.1L)
1987	
Selec-Trac	2.5 Pts. (1.2L)
Command-Trac	2.2 Pts. (1.0L)
1988	
Selec-Trac	3.0 Pts. (1.4L)
Command-Trac	2.2 Pts. (1.0L)
Drive Axles (3)	
Front	2.5 Pts. (1.2L)
Front (Disconnect Housing)	5.0 Ozs. (0.15L)
Rear	2.5 Pts. (1.2L)

Rear (Trac-Lok) (4) 2.5 Pts. (1.2L)

- (1) - Capacities are recommended or calculated levels. Always use dipstick (if available) to measure level.
- (2) - Includes 2.3 qts. for coolant recovery bottle.
- (3) - Fill to bottom of filler plug hole.
- (4) - Add 4 ozs. (118 ml) of Limited-Slip differential lubricant additive first, then add new fluid.

90,000 MILE (144,000 KM) SERVICE

90,000 MILE (144,000 KM) SERVICE

Service Or Inspect
Verify Last Major Service Was Performed
Check Fluid Levels
Check Fuel Lines, Connections
Check Cooling System Hoses and Clamps
Check Coolant Strength
Clean Battery and Battery Terminals
Accessory Drive Belts
Clean Choke Linkage
Check Exhaust System & Heat Shielding
Check Operation of Horn, Wipers/Washers & All Exterior Lights
Inspect Condition of Wiper Blades
Check Headlight Alignment
Check Seat Belt Webbing and Release Mechanisms
Check Parking Brake Operation
Check Shift/Clutch Interlock Operation
Adjust Drive Belt Tension
Inspect C/V Joint boots (4WD)
Inspect Underside of Vehicle (Bolts & Threaded Fasteners)
Check/Lube Manual Steering Gear
Check Drive Shaft Seals
Lubricate Ball Joints, Steering Linkage & Suspension
Lube Drive Shaft U-Joints and Slip Splines
Lube Front Axle Drive Joint and Pivot Bearings (4WD)

Lube Parking Brake Ratio Lever Pivot	
Lube Manual Gearshift Control (4WD Transfer Case)	
Inspect/Repack Front Wheel Bearings (2WD Models)	
Inspect Front Brake Pads & Rotors	
Lubricate Caliper Slide Rails	
Inspect Rear Brake Linings & Drums	
Inspect Brake System Hoses & Lines	
Inspect Shocks for Leakage	
Inspect Tire Wear Pattern	
Lubricate Weatherstripping with Silicone	
Lubricate Door Hinges	
Lubricate Door Locks	
Check Body Drain Holes	
Rotate Tires and Adjust Air Pressure	
Replace	
Engine Oil	
Oil Filter	
Air Filter Element	
Fuel Filter	
Spark Plugs	
Automatic Transmission Fluid, Filter and Adjust Bands	
PCV Filter	
PCV Valve (1) (2)	
Drive Belt (V-Type) (2) (3)	
(1) - Replacement is recommended by Chrysler at this time, but it is not required to maintain the warranty on the PCV valve. (2) - Not required, if belt or PCV Valve was previously replaced (3) - Check and replace as needed.	
Lubrication Specifications	
Application	Specification
Automatic Transmission	Dexron-IIe ATF
Brake Master Cylinder	DOT 3 (SAE J-1703F) Brake Fluid
Engine Coolant	Alugard 340-2 & Water (50/50 Mixture)
Engine Oil (1)	
Gasoline Engine	
Temperature Range	

Above 30° F (-1°C)	SAE 20W-40 Or 20W-50 API SH/CD
Above 0° F (-18°C)	SAE 10W-30 Or 10W-40 API SH/CD
Less Than 60° F (16°C)	SAE 5W-30 API SH/CD
Drive Axles	SAE 75W-90 API GL-5
Drive Axles (Trac-Lok) (2)	SAE 80W-140 API GL-5
Drive Axles (Trailer Towing)	SAE 80W-140 API GL-5
Hydraulic Clutch	DOT 3 (SAE J-1703F) Brake Fluid
Manual Transmission	SAE 75W-90 API GL-5
Parking Brake Cable Guides	NLGI Grade 2, GC-LB
Door & Hood Hinges	Light Engine Oil
Manual Steering Box	Multi-Purpose NLGI Grade 2EP
Power Steering Pump	Power Steering Fluid
Transfer Case	Dexron-II E ATF
Brake Caliper Bushings	GE 661 or DOW 111 Silicone Grease
Caliper Slide Pins	GE 661 or DOW 111 Silicone Grease
Wheel Bearings	Multi-Purpose NLGI Grade GC-LB
Drive Shaft U-Joints	Multi-Purpose NLGI Grade 2EP
Steering Linkage (4) (5)	NLGI Grade 2, GC-LB
Ball Joints (4) (6)	NLGI Grade 2, GC-LB
Weatherstrip	Silicone Spray Lubricant
Wheel Lug Nut Torque	95 ft. lbs. (129 N.m)

- (1) - SAE 10W-30 SH/CD is preferred.
- (2) - Add 4 ozs. (118 ml) of Limited-Slip differential lubricant additive when changing fluid.
- (3) - For vehicles operating under heavy-duty towing conditions, use SAE 75W-140 Synthetic lube.
NOTE: Before using SAE 75W-140 Synthetic the old fluid must be DRAINED and FLUSHED with clean mineral based axle lubricant. Then refill with new synthetic lube.
- (4) - Use low pressure grease gun to prevent seal damage.
- (5) - Fill until lubricant squeezes out from the base of seals.
- (6) - Fill ball joint until seal starts to swell.

Fluid Capacities

Application	(1) Quantity
Automatic Transmission	
1984-86 (904 HD)	
Fluid Change	4.0 Qts. (3.8L)
Overhaul (Dry Fill)	8.0 Qts. (7.6L)
1987-88	
Fluid Change	4.0 Qts. (3.8L)
Overhaul (Dry Fill)	8.5 Qts. (8.0L)
Cooling System (2)	
4-Cylinder	10.0 Qts. (9.5L)
6-Cylinder	12.0 Qts. (11.4L)
Engine Oil	
4-Cylinder	4.0 Qts. (3.8L)
6-Cylinder	6.0 Qts. (5.7L)
Fuel Tank	
Standard	13.5 Gals. (51.1L)
Optional	20 Gals. (75.7L)
Manual Transmission (3)	
AX4 (AISIN)	7.4 Pts. (3.5L)
T4 (Borg-Warner)	3.9 Pts. (1.8L)
AX5 (AISIN)	7.0 Pts. (3.3L)
T5 (Borg-Warner)	4.5 Pts. (2.1L)
Transfer Case	
1985-86	
Selec-Trac (229 Full-Time)	6.0 Pts. (2.8L)
Command-Trac (Part-Time 207)	4.5 Pts. (2.1L)

1987		
Selec-Trac	2.5 Pts. (1.2L)
Command-Trac	2.2 Pts. (1.0L)
1988		
Selec-Trac	3.0 Pts. (1.4L)
Command-Trac	2.2 Pts. (1.0L)
Drive Axles (3)		
Front	2.5 Pts. (1.2L)
Front (Disconnect Housing)	5.0 Ozs. (0.15L)
Rear	2.5 Pts. (1.2L)
Rear (Trac-Lok) (4)	2.5 Pts. (1.2L)
<p>(1) - Capacities are recommended or calculated levels. Always use dipstick (if available) to measure level. (2) - Includes 2.3 qts. for coolant recovery bottle. (3) - Fill to bottom of filler plug hole. (4) - Add 4 ozs. (118 ml) of Limited-Slip differential lubricant additive first, then add new fluid.</p>		

Service Labor Times	
Application	(1) Hours
2.5L	
Automatic Transmission	5.6
Manual Transmission	4.9
2.8L	
Automatic Transmission	5.8
Manual Transmission	5.1
4.0L	
Automatic Transmission	5.7
Manual Transmission	5.0
<p>(1) - Add .8 hr. for vehicles equipped with 4WD.</p>	

97,500 MILE (156,000 KM) SERVICE

97,500 MILE (156,000 KM) SERVICE

Service Or Inspect
Verify Last Major Service Was Performed
Check Fluid Levels
Check Cooling System Hoses and Clamps
Check Exhaust System & Heat Shielding
Inspect Brake System
Inspect Front Wheel Bearings
Inspect C/V Joint boots (4WD)
Inspect Underside of Vehicle (Bolts & Threaded Fasteners)
Check/Lube Manual Steering Gear
Check Drive Shaft Seals

Lubricate Ball Joints, Steering Linkage & Suspension
Lube Drive Shaft U-Joints and Slip Splines
Lube Front Axle Drive Joint and Pivot Bearings (4WD)
Rotate Tires and Adjust Air Pressure (Including Spare)
Replace
Engine Oil
Oil Filter, if it has not been changed in the last 12 months

Lubrication Specifications

Application	Specification
Automatic Transmission	Dexron-II E ATF
Brake Master Cylinder	DOT 3 (SAE J-1703F) Brake Fluid
Engine Coolant	Alugard 340-2 & Water (50/50 Mixture)
Engine Oil (1)	
Gasoline Engine	
Temperature Range	
Above 30° F (-1°C)	SAE 20W-40 Or 20W-50 API SH/CD
Above 0° F (-18°C)	SAE 10W-30 Or 10W-40 API SH/CD
Less Than 60° F (16°C)	SAE 5W-30 API SH/CD
Drive Axles	SAE 75W-90 API GL-5
Drive Axles (Trac-Lok) (2)	SAE 80W-140 API GL-5
Drive Axles (Trailer Towing)	SAE 80W-140 API GL-5
Hydraulic Clutch	DOT 3 (SAE J-1703F) Brake Fluid
Manual Transmission	SAE 75W-90 API GL-5
Parking Brake Cable Guides	NLGI Grade 2, GC-LB
Door & Hood Hinges	Light Engine Oil
Manual Steering Box	Multi-Purpose NLGI Grade 2EP
Power Steering Pump	Power Steering Fluid
Transfer Case	Dexron-II E ATF
Brake Caliper Bushings	GE 661 or DOW 111 Silicone Grease
Caliper Slide Pins	GE 661 or DOW 111 Silicone Grease
Wheel Bearings	Multi-Purpose NLGI Grade GC-LB
Drive Shaft U-Joints	Multi-Purpose NLGI Grade 2EP
Steering Linkage (4) (5)	NLGI Grade 2, GC-LB
Ball Joints (4) (6)	NLGI Grade 2, GC-LB
Weatherstrip	Silicone Spray Lubricant
Wheel Lug Nut Torque	95 ft. lbs. (129 N.m)
(1) - SAE 10W-30 SH/CD is preferred.	
(2) - Add 4 ozs. (118 ml) of Limited-Slip differential lubricant additive when changing fluid.	
(3) - For vehicles operating under heavy-duty towing conditions, use SAE 75W-140 Synthetic lube.	
NOTE: Before using SAE 75W-140 Synthetic the old fluid must be DRAINED and FLUSHED with clean mineral based axle lubricant. Then refill with new synthetic lube.	
(4) - Use low pressure grease gun to prevent seal damage.	
(5) - Fill until lubricant squeezes out from the base of seals.	
(6) - Fill ball joint until seal starts to swell.	

Fluid Capacities

Application	(1) Quantity
Automatic Transmission	

1984-86 (904 HD)		
Fluid Change	4.0 Qts.	(3.8L)
Overhaul (Dry Fill)	8.0 Qts.	(7.6L)
1987-88		
Fluid Change	4.0 Qts.	(3.8L)
Overhaul (Dry Fill)	8.5 Qts.	(8.0L)
Cooling System (2)		
4-Cylinder	10.0 Qts.	(9.5L)
6-Cylinder	12.0 Qts.	(11.4L)
Engine Oil		
4-Cylinder	4.0 Qts.	(3.8L)
6-Cylinder	6.0 Qts.	(5.7L)
Fuel Tank		
Standard	13.5 Gals.	(51.1L)
Optional	20 Gals.	(75.7L)
Manual Transmission (3)		
AX4 (AISIN)	7.4 Pts.	(3.5L)
T4 (Borg-Warner)	3.9 Pts.	(1.8L)
AX5 (AISIN)	7.0 Pts.	(3.3L)
T5 (Borg-Warner)	4.5 Pts.	(2.1L)
Transfer Case		
1985-86		
Selec-Trac (229 Full-Time)	6.0 Pts.	(2.8L)
Command-Trac (Part-Time 207)	4.5 Pts.	(2.1L)
1987		
Selec-Trac	2.5 Pts.	(1.2L)
Command-Trac	2.2 Pts.	(1.0L)
1988		
Selec-Trac	3.0 Pts.	(1.4L)
Command-Trac	2.2 Pts.	(1.0L)
Drive Axles (3)		
Front	2.5 Pts.	(1.2L)
Front (Disconnect Housing)	5.0 Ozs.	(0.15L)
Rear	2.5 Pts.	(1.2L)
Rear (Trac-Lok) (4)	2.5 Pts.	(1.2L)

- (1) - Capacities are recommended or calculated levels. Always use dipstick (if available) to measure level.
(2) - Includes 2.3 qts. for coolant recovery bottle.
(3) - Fill to bottom of filler plug hole.
(4) - Add 4 ozs. (118 ml) of Limited-Slip differential lubricant additive first, then add new fluid.

105,000 MILE (168,000 KM) SERVICE

105,000 MILE (168,000 KM) SERVICE

Service Or Inspect	
	Verify Last Major Service Was Performed
	Check Fluid Levels
	Check Fuel Lines, Connections
	Check Cooling System Hoses and Clamps
	Check Coolant Strength
	Check Exhaust System & Heat Shielding

Clean Battery and Battery Terminals	
Inspect Brake System	
Check Operation of Horn, Wipers/Washers & All Exterior Lights	
Inspect Condition of Wiper Blades	
Check Headlight Alignment	
Check Seat Belt Webbing and Release Mechanisms	
Check Parking Brake Operation	
Check Shift/Clutch Interlock Operation	
Inspect C/V Joint boots (4WD)	
Inspect Underside of Vehicle (Bolts & Threaded Fasteners)	
Check/Lube Manual Steering Gear	
Check Drive Shaft Seals	
Lubricate Ball Joints, Steering Linkage & Suspension	
Lube Drive Shaft U-Joints and Slip Splines	
Lube Front Axle Drive Joint and Pivot Bearings (4WD)	
Inspect Front Wheel Bearings (4WD)	
Lubricate Weatherstripping with Silicone	
Lubricate Door Hinges	
Lubricate Door Locks	
Check Body Drain Holes	
Rotate Tires and Adjust Air Pressure	
Replace	
Engine Oil	
Oil Filter	
Flush and Fill Engine Coolant, if not done in last 24 months	
Lubrication Specifications	
Application	Specification
Automatic Transmission	Dexron-II E ATF
Brake Master Cylinder	DOT 3 (SAE J-1703F) Brake Fluid
Engine Coolant	Alugard 340-2 & Water (50/50 Mixture)
Engine Oil (1)	
Gasoline Engine	
Temperature Range	
Above 30° F (-1°C)	SAE 20W-40 Or 20W-50 API SH/CD
Above 0° F (-18°C)	SAE 10W-30 Or 10W-40 API SH/CD
Less Than 60° F (16°C)	SAE 5W-30 API SH/CD

Drive Axles	SAE 75W-90 API GL-5
Drive Axles (Trac-Lok) (2)	SAE 80W-140 API GL-5
Drive Axles (Trailer Towing)	SAE 80W-140 API GL-5
Hydraulic Clutch	DOT 3 (SAE J-1703F) Brake Fluid
Manual Transmission	SAE 75W-90 API GL-5
Parking Brake Cable Guides	NLGI Grade 2, GC-LB
Door & Hood Hinges	Light Engine Oil
Manual Steering Box	Multi-Purpose NLGI Grade 2EP
Power Steering Pump	Power Steering Fluid
Transfer Case	Dexron-II E ATF
Brake Caliper Bushings	GE 661 or DOW 111 Silicone Grease
Caliper Slide Pins	GE 661 or DOW 111 Silicone Grease
Wheel Bearings	Multi-Purpose NLGI Grade GC-LB
Drive Shaft U-Joints	Multi-Purpose NLGI Grade 2EP
Steering Linkage (4) (5)	NLGI Grade 2, GC-LB
Ball Joints (4) (6)	NLGI Grade 2, GC-LB
Weatherstrip	Silicone Spray Lubricant
Wheel Lug Nut Torque	95 ft. lbs. (129 N.m)

- (1) - SAE 10W-30 SH/CD is preferred.
- (2) - Add 4 ozs. (118 ml) of Limited-Slip differential lubricant additive when changing fluid.
- (3) - For vehicles operating under heavy-duty towing conditions, use SAE 75W-140 Synthetic lube.
NOTE: Before using SAE 75W-140 Synthetic the old fluid must be DRAINED and FLUSHED with clean mineral based axle lubricant. Then refill with new synthetic lube.
- (4) - Use low pressure grease gun to prevent seal damage.
- (5) - Fill until lubricant squeezes out from the base of seals.
- (6) - Fill ball joint until seal starts to swell.

Fluid Capacities

Application	(1) Quantity
Automatic Transmission	
1984-86 (904 HD)	
Fluid Change	4.0 Qts. (3.8L)
Overhaul (Dry Fill)	8.0 Qts. (7.6L)
1987-88	
Fluid Change	4.0 Qts. (3.8L)
Overhaul (Dry Fill)	8.5 Qts. (8.0L)
Cooling System (2)	
4-Cylinder	10.0 Qts. (9.5L)
6-Cylinder	12.0 Qts. (11.4L)
Engine Oil	
4-Cylinder	4.0 Qts. (3.8L)
6-Cylinder	6.0 Qts. (5.7L)
Fuel Tank	
Standard	13.5 Gals. (51.1L)
Optional	20 Gals. (75.7L)
Manual Transmission (3)	
AX4 (AISIN)	7.4 Pts. (3.5L)
T4 (Borg-Warner)	3.9 Pts. (1.8L)
AX5 (AISIN)	7.0 Pts. (3.3L)
T5 (Borg-Warner)	4.5 Pts. (2.1L)
Transfer Case	
1985-86	
Selec-Trac (229 Full-Time)	6.0 Pts. (2.8L)
Command-Trac (Part-Time 207)	4.5 Pts. (2.1L)
1987	
Selec-Trac	2.5 Pts. (1.2L)
Command-Trac	2.2 Pts. (1.0L)

1988

Selec-Trac	3.0 Pts. (1.4L)
Command-Trac	2.2 Pts. (1.0L)
Drive Axles (3)	
Front	2.5 Pts. (1.2L)
Front (Disconnect Housing)	5.0 Ozs. (0.15L)
Rear	2.5 Pts. (1.2L)
Rear (Trac-Lok) (4)	2.5 Pts. (1.2L)

- (1) - Capacities are recommended or calculated levels. Always use dipstick (if available) to measure level.
- (2) - Includes 2.3 qts. for coolant recovery bottle.
- (3) - Fill to bottom of filler plug hole.
- (4) - Add 4 ozs. (118 ml) of Limited-Slip differential lubricant additive first, then add new fluid.

112,500 MILE (180,000 KM) SERVICE

112,500 MILE (180,000 KM) SERVICE

Service Or Inspect
Verify Last Major Service Was Performed
Check Fluid Levels
Check Cooling System Hoses and Clamps
Check Coolant Strength
Clean Battery and Battery Terminals
Check Exhaust System & Heat Shielding
Check Operation of Horn, Wipers/Washers & All Exterior Lights
Inspect Condition of Wiper Blades
Check Headlight Alignment
Check Seat Belt Webbing and Release Mechanisms
Check Parking Brake Operation
Check Shift/Clutch Interlock Operation
Inspect C/V Joint boots (4WD)
Inspect Underside of Vehicle (Bolts & Threaded Fasteners)
Check/Lube Manual Steering Gear
Check Drive Shaft Seals
Lubricate Ball Joints, Steering Linkage & Suspension
Lube Drive Shaft U-Joints and Slip Splines
Lube Front Axle Drive Joint and Pivot Bearings (4WD)
Lube Parking Brake Ratio Lever Pivot

Lube Manual Gearshift Control (4WD Transfer Case)
Inspect/Repack Front Wheel Bearings (2WD Models)
Inspect Front Brake Pads & Rotors
Lubricate Caliper Slide Rails
Inspect Rear Brake Linings & Drums
Inspect Brake System Hoses & Lines
Inspect Shocks for Leakage
Inspect Tire Wear Pattern
Lubricate Weatherstripping with Silicone
Lubricate Door Hinges
Lubricate Door Locks
Check Body Drain Holes
Rotate Tires and Adjust Air Pressure
Replace
Engine Oil
Oil Filter, if it has not been changed in the last 12 months
Manual Transmission Fluid
Automatic Transmission Fluid, Filter and Adjust Bands
Transfer Case Fluid
Flush and Fill Engine Coolant, if not done in last 24 months
Lubrication Specifications

Application	Specification
Automatic Transmission	Dexron-II E ATF
Brake Master Cylinder	DOT 3 (SAE J-1703F) Brake Fluid
Engine Coolant	Alugard 340-2 & Water (50/50 Mixture)
Engine Oil (1)	
Gasoline Engine	
Temperature Range	
Above 30° F (-1°C)	SAE 20W-40 Or 20W-50 API SH/CD
Above 0° F (-18°C)	SAE 10W-30 Or 10W-40 API SH/CD
Less Than 60° F (16°C)	SAE 5W-30 API SH/CD
Drive Axles	SAE 75W-90 API GL-5
Drive Axles (Trac-Lok) (2)	SAE 80W-140 API GL-5
Drive Axles (Trailer Towing)	SAE 80W-140 API GL-5
Hydraulic Clutch	DOT 3 (SAE J-1703F) Brake Fluid
Manual Transmission	SAE 75W-90 API GL-5
Parking Brake Cable Guides	NLGI Grade 2, GC-LB
Door & Hood Hinges	Light Engine Oil
Manual Steering Box	Multi-Purpose NLGI Grade 2EP
Power Steering Pump	Power Steering Fluid

Transfer Case	Dexron-II E ATF
Brake Caliper Bushings	GE 661 or DOW 111 Silicone Grease
Caliper Slide Pins	GE 661 or DOW 111 Silicone Grease
Wheel Bearings	Multi-Purpose NLGI Grade GC-LB
Drive Shaft U-Joints	Multi-Purpose NLGI Grade 2EP
Steering Linkage (4) (5)	NLGI Grade 2, GC-LB
Ball Joints (4) (6)	NLGI Grade 2, GC-LB
Weatherstrip	Silicone Spray Lubricant
Wheel Lug Nut Torque	95 ft. lbs. (129 N.m)

- (1) - SAE 10W-30 SH/CD is preferred.
- (2) - Add 4 ozs. (118 ml) of Limited-Slip differential lubricant additive when changing fluid.
- (3) - For vehicles operating under heavy-duty towing conditions, use SAE 75W-140 Synthetic lube.
NOTE: Before using SAE 75W-140 Synthetic the old fluid must be DRAINED and FLUSHED with clean mineral based axle lubricant. Then refill with new synthetic lube.
- (4) - Use low pressure grease gun to prevent seal damage.
- (5) - Fill until lubricant squeezes out from the base of seals.
- (6) - Fill ball joint until seal starts to swell.

Fluid Capacities

Application	(1) Quantity
Automatic Transmission	
1984-86 (904 HD)	
Fluid Change	4.0 Qts. (3.8L)
Overhaul (Dry Fill)	8.0 Qts. (7.6L)
1987-88	
Fluid Change	4.0 Qts. (3.8L)
Overhaul (Dry Fill)	8.5 Qts. (8.0L)
Cooling System (2)	
4-Cylinder	10.0 Qts. (9.5L)
6-Cylinder	12.0 Qts. (11.4L)
Engine Oil	
4-Cylinder	4.0 Qts. (3.8L)
6-Cylinder	6.0 Qts. (5.7L)
Fuel Tank	
Standard	13.5 Gals. (51.1L)
Optional	20 Gals. (75.7L)
Manual Transmission (3)	
AX4 (AISIN)	7.4 Pts. (3.5L)
T4 (Borg-Warner)	3.9 Pts. (1.8L)
AX5 (AISIN)	7.0 Pts. (3.3L)
T5 (Borg-Warner)	4.5 Pts. (2.1L)
Transfer Case	
1985-86	
Selec-Trac (229 Full-Time)	6.0 Pts. (2.8L)
Command-Trac (Part-Time 207)	4.5 Pts. (2.1L)
1987	
Selec-Trac	2.5 Pts. (1.2L)
Command-Trac	2.2 Pts. (1.0L)
1988	
Selec-Trac	3.0 Pts. (1.4L)
Command-Trac	2.2 Pts. (1.0L)
Drive Axles (3)	
Front	2.5 Pts. (1.2L)
Front (Disconnect Housing)	5.0 Ozs. (0.15L)
Rear	2.5 Pts. (1.2L)
Rear (Trac-Lok) (4)	2.5 Pts. (1.2L)

- (1) - Capacities are recommended or calculated levels. Always use dipstick (if available) to measure level.
- (2) - Includes 2.3 qts. for coolant recovery bottle.
- (3) - Fill to bottom of filler plug hole.
- (4) - Add 4 ozs. (118 ml) of Limited-Slip differential lubricant additive first, then add new fluid.

120,000 MILE (192,000 KM) SERVICE

120,000 MILE (192,000 KM) SERVICE

Service Or Inspect
Verify Last Major Service Was Performed
Check Fluid Levels
Check Cooling System Hoses and Clamps
Check Coolant Strength
Check Accessory Drive Belts
Check Exhaust System & Heat Shielding
Clean Battery and Battery Terminals
Adjust Drive Belt Tension
Accessory Drive Belts
Adjust Idle - Propane Method (1987-88)
Ignition Timing
Lubricate Manifold Heat Control Valve (3.9L & 5.2L Engines)
Clean PCV Breather (3.9L & 5.2L Engines)
Clean EGR Passages (if equipped)
Inspect C/V Joint boots (4WD)
Inspect Underside of Vehicle (Bolts & Threaded Fasteners)
Check/Lube Manual Steering Gear
Check Drive Shaft Seals
Lubricate Ball Joints, Steering Linkage & Suspension
Lube Drive Shaft U-Joints and Slip Splines
Lube Front Axle Drive Joint and Pivot Bearings (4WD)
Inspect Front Wheel Bearings (4WD)
Clean and Lubricate Crankcase Inlet Air Cleaner
Suspension Bushings, Springs, Arms & Rear Jounce Bumpers

Parking Brake System
Inspect Shocks for Leakage
Inspect Tire Wear Pattern
Rotate Tires and Adjust Air Pressure (Including Spare)
Replace
Engine Oil
Oil Filter
Spark Plugs
Ignition Cables
Distributor Cap and Rotor
Air Filter Element
Fuel Filter
PCV Valve (1)
PCV Filter
EGR Valve & Tube (1987-92)
Vacuum Operated Emission Components (1987-92)
PCV Valve (1)
Drive Belt (V-Type) (2)
Flush and Fill Engine Coolant, if not done in last 24 months
Automatic Transmission Fluid, Filter and Adjust Bands

- (1) - Replacement is recommended by Chrysler at this time, but it is not required to maintain the warranty on the PCV valve.
(2) - Check and replace as needed.

Lubrication Specifications

Application	Specification
Automatic Transmission	Dexron-II E ATF
Brake Master Cylinder	DOT 3 (SAE J-1703F) Brake Fluid
Engine Coolant	Alugard 340-2 & Water (50/50 Mixture)
Engine Oil (1)	
Gasoline Engine	
Temperature Range	
Above 30° F (-1°C)	SAE 20W-40 Or 20W-50 API SH/CD
Above 0° F (-18°C)	SAE 10W-30 Or 10W-40 API SH/CD
Less Than 60° F (16°C)	SAE 5W-30 API SH/CD
Drive Axles	SAE 75W-90 API GL-5
Drive Axles (Trac-Lok) (2)	SAE 80W-140 API GL-5
Drive Axles (Trailer Towing)	SAE 80W-140 API GL-5
Hydraulic Clutch	DOT 3 (SAE J-1703F) Brake Fluid
Manual Transmission	SAE 75W-90 API GL-5
Parking Brake Cable Guides	NLGI Grade 2, GC-LB

Door & Hood Hinges	Light Engine Oil
Manual Steering Box	Multi-Purpose NLGI Grade 2EP
Power Steering Pump	Power Steering Fluid
Transfer Case	Dexron-II E ATF
Brake Caliper Bushings	GE 661 or DOW 111 Silicone Grease
Caliper Slide Pins	GE 661 or DOW 111 Silicone Grease
Wheel Bearings	Multi-Purpose NLGI Grade GC-LB
Drive Shaft U-Joints	Multi-Purpose NLGI Grade 2EP
Steering Linkage (4)(5)	NLGI Grade 2, GC-LB
Ball Joints (4)(6)	NLGI Grade 2, GC-LB
Weatherstrip	Silicone Spray Lubricant
Wheel Lug Nut Torque	95 ft. lbs. (129 N.m)

- (1) - SAE 10W-30 SH/CD is preferred.
- (2) - Add 4 ozs. (118 ml) of Limited-Slip differential lubricant additive when changing fluid.
- (3) - For vehicles operating under heavy-duty towing conditions, use SAE 75W-140 Synthetic lube.
NOTE: Before using SAE 75W-140 Synthetic the old fluid must be DRAINED and FLUSHED with clean mineral based axle lubricant. Then refill with new synthetic lube.
- (4) - Use low pressure grease gun to prevent seal damage.
- (5) - Fill until lubricant squeezes out from the base of seals.
- (6) - Fill ball joint until seal starts to swell.

Fluid Capacities

Application	(1) Quantity
Automatic Transmission	
1984-86 (904 HD)	
Fluid Change	4.0 Qts. (3.8L)
Overhaul (Dry Fill)	8.0 Qts. (7.6L)
1987-88	
Fluid Change	4.0 Qts. (3.8L)
Overhaul (Dry Fill)	8.5 Qts. (8.0L)
Cooling System (2)	
4-Cylinder	10.0 Qts. (9.5L)
6-Cylinder	12.0 Qts. (11.4L)
Engine Oil	
4-Cylinder	4.0 Qts. (3.8L)
6-Cylinder	6.0 Qts. (5.7L)
Fuel Tank	
Standard	13.5 Gals. (51.1L)
Optional	20 Gals. (75.7L)
Manual Transmission (3)	
AX4 (AISIN)	7.4 Pts. (3.5L)
T4 (Borg-Warner)	3.9 Pts. (1.8L)
AX5 (AISIN)	7.0 Pts. (3.3L)
T5 (Borg-Warner)	4.5 Pts. (2.1L)
Transfer Case	
1985-86	
Selec-Trac (229 Full-Time)	6.0 Pts. (2.8L)
Command-Trac (Part-Time 207)	4.5 Pts. (2.1L)
1987	
Selec-Trac	2.5 Pts. (1.2L)
Command-Trac	2.2 Pts. (1.0L)
1988	
Selec-Trac	3.0 Pts. (1.4L)
Command-Trac	2.2 Pts. (1.0L)
Drive Axles (3)	
Front	2.5 Pts. (1.2L)
Front (Disconnect Housing)	5.0 Ozs. (0.15L)

Rear 2.5 Pts. (1.2L)
Rear (Trac-Lok) (4) 2.5 Pts. (1.2L)

- (1) - Capacities are recommended or calculated levels. Always use dipstick (if available) to measure level.
- (2) - Includes 2.3 qts. for coolant recovery bottle.
- (3) - Fill to bottom of filler plug hole.
- (4) - Add 4 ozs. (118 ml) of Limited-Slip differential lubricant additive first, then add new fluid.

Service Labor Times

Application	Hours
2.5L	
Automatic Transmission	3.5
Manual Transmission	3.5
2.8L	
Automatic Transmission	3.7
Manual Transmission	3.7
4.0L	
Automatic Transmission	3.6
Manual Transmission	3.6

LUBRICATION SPECIFICATIONS

LUBRICATION SPECIFICATIONS TABLE

Application	Fluid Specifications
Automatic Transmission	Dexron-II E ATF
Brake Master Cylinder	DOT 3 (SAE J-1703F) Brake Fluid
Engine Coolant	Alugard 340-2 & Water (50/50 Mixture)
Engine Oil (1)	
Gasoline Engine	
Temperature Range	
Above 30° F (-1°C)	SAE 20W-40 Or 20W-50 API SH/CD
Above 0° F (-18°C)	SAE 10W-30 Or 10W-40 API SH/CD
Less Than 60° F (16°C)	SAE 5W-30 API SH/CD
Drive Axles	SAE 75W-90 API GL-5
Drive Axles (Trac-Lok) (2)	SAE 80W-140 API GL-5
Drive Axles (Trailer Towing)	SAE 80W-140 API GL-5
Hydraulic Clutch	DOT 3 (SAE J-1703F) Brake Fluid
Manual Transmission	SAE 75W-90 API GL-5
Manual Steering Box	Multi-Purpose NLGI Grade 2EP
Power Steering Pump	Power Steering Fluid
Transfer Case	Dexron-II E ATF
Brake Caliper Bushings	GE 661 or DOW 111 Silicone Grease
Caliper Slide Pins	GE 661 or DOW 111 Silicone Grease
Wheel Bearings	Mopar Multi-Purpose NLGI Grade GC-LB
Drive Shaft U-Joints	Mopar Multi-Purpose NLGI Grade 2EP
Steering Linkage (4) (5)	Mopar Multi-mileage or equivalent
Ball Joints (4) (6)	Mopar Multi-mileage or equivalent
Weatherstrip	Silicone Spray Lubricant

- (1) - SAE 10W-30 SH/CD is preferred.
 - (2) - Add 4 ozs. (118 ml) of Limited-Slip differential lubricant additive when changing fluid.
 - (3) - For vehicles operating under heavy-duty towing conditions, use SAE 75W-140 Synthetic lube.
- NOTE: Before using SAE 75W-140 Synthetic the old fluid must be

- DRAINED and FLUSHED with clean mineral based (non-synthetic) axle lubricant. Then refill with new synthetic lube.
- (4) - Use low pressure grease gun to prevent seal damage.
 - (5) - Fill until lubricant squeezes out from the base of seals.
 - (6) - Fill ball joint until seal starts to swell.
-

FLUID CAPACITIES

FLUID CAPACITIES TABLE

Application	Quantity (1)
A/C System R-12 Refrigerant Capacity	36-40 Ozs.
Automatic Transmission	
1984-86 (904 HD)	
Fluid Change	4.0 Qts. (3.8L)
Overhaul (Dry Fill)	8.0 Qts. (7.6L)
1987-88	
Fluid Change	4.0 Qts. (3.8L)
Overhaul (Dry Fill)	8.5 Qts. (8.0L)
Cooling System (2)	
4-Cylinder	10.0 Qts. (9.5L)
6-Cylinder	12.0 Qts. (11.4L)
Engine Oil	
4-Cylinder	4.0 Qts. (3.8L)
6-Cylinder	6.0 Qts. (5.7L)
Fuel Tank	
Standard	13.5 Gals. (51.1L)
Optional	20 Gals. (75.7L)
Manual Transmission (3)	
AX4 (AISIN)	7.4 Pts. (3.5L)
T4 (Borg-Warner)	3.9 Pts. (1.8L)
AX5 (AISIN)	7.0 Pts. (3.3L)
T5 (Borg-Warner)	4.5 Pts. (2.1L)
Transfer Case	
1985-86	
Selec-Trac (229 Full-Time)	6.0 Pts. (2.8L)
Command-Trac (Part-Time 207)	4.5 Pts. (2.1L)
1987	
Selec-Trac	2.5 Pts. (1.2L)
Command-Trac	2.2 Pts. (1.0L)
1988	
Selec-Trac	3.0 Pts. (1.4L)
Command-Trac	2.2 Pts. (1.0L)
Drive Axles (3)	
Front	2.5 Pts. (1.2L)
Front (Disconnect Housing)	5.0 Ozs. (0.15L)
Rear	2.5 Pts. (1.2L)
Rear (Trac-Lok) (4)	2.5 Pts. (1.2L)

- (1) - Capacities are recommended or calculated levels. Always use dipstick (if available) to measure level.
 - (2) - Includes 2.3 qts. for coolant recovery bottle.
 - (3) - Fill to bottom of filler plug hole.
 - (4) - Add 4 ozs. (118 ml) of Limited-Slip differential lubricant additive first, then add new fluid.
-