

STEERING KNUCKLES - 4WD

1988 Jeep Cherokee

1988 4WD Steering Knuckles
ALL MANUFACTURERS

DESCRIPTION

Open type steering knuckles are used on all models. Open type knuckles provide sharper turning angle, which will decrease vehicle turning radius. Axle shafts are free floating. Depending upon vehicle model, steering knuckles can be attached to axle housing by either ball joints or roller bearings and king (pivot) pins.

OVERHAUL

BALL JOINT TYPE

Disassembly

1) Raise vehicle and support securely. Remove wheels. Remove brake caliper and rotor. If equipped, remove locking hubs. See appropriate LOCKING HUBS article in DRIVE AXLE section.

2) Disconnect tie rod end from steering knuckle. Remove spindle nuts and lightly tap spindle with soft face hammer to free it from steering knuckle. Pull out axle shaft assembly.

3) Clean all components with solvent and dry with compressed air. Inspect all parts for burrs, chips, wear, flat spots or cracks. Replace all damaged or worn parts.

NOTE: When aligning upper ball joint nut to install cotter pin, always tighten nut to align. Never loosen nut to align holes.

Reassembly

To reassemble, reverse disassembly procedure. Torque all fittings to specifications.

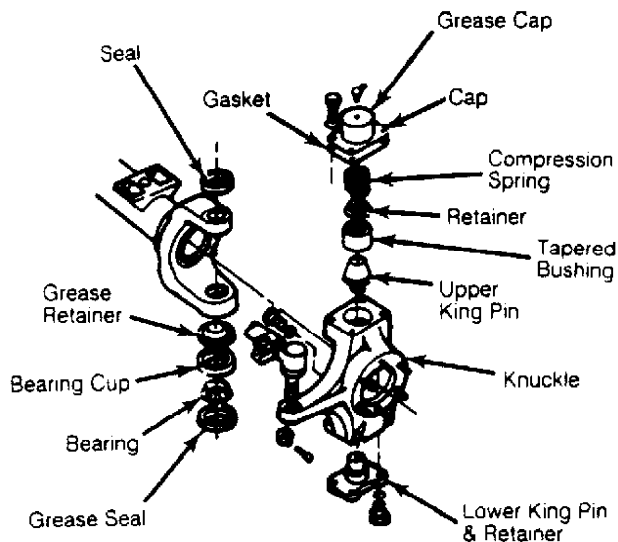

Fig. 1: Exploded View of Steering Knuckle Assembly

ADJUSTMENT

NOTE: All other models are not adjustable.

BALL JOINTS

Jeep, Truck & Wagoneer

1) Raise vehicle and remove front wheels. Disconnect steering damper and connecting rod. Remove cotter pin from right side tie rod retaining nut. Rotate steering knuckles through complete arc several times.

2) Place torque wrench on right side tie rod retaining nut. Torque to turn knuckles through complete arc should not be more than 25 ft. lbs. (34 N.m).

3) If turning effort is excessive, disconnect tie rod ends at knuckles. Measure turning effort of right and left side knuckles. Individual turning effort should not be more than 10 ft. lbs. (14 N.m).

4) If individual turning effort is more than specified, replace upper ball joint split ring seat. If turning effort is more than 10 ft. lbs. (14 N.m) after split ring seat replacement, ball joints will have to be replaced.

TURNING ANGLE

Truck & Wagoneer

1) Turning angle stop screws are located at rear of steering knuckle, just above axle centerline. To adjust, loosen lock nut on turning angle stop screw. Jeep turning angle is not adjustable.

2) Using turntable to measure angle, adjust stop screw to obtain specified angle. Tighten lock nut without changing setting.

TURN ANGLE ADJUSTMENT

TURNING ANGLE ADJUSTMENT TABLE

Application	Left Wheel	Right Wheel
Jeep Cherokee, Comanche, & Wrangler	(1) 32-33°	(1) 32-33°
Wagoneer	36-37°	36-37°

(1) - Angle stops are not adjustable. Parts must be replaced if angle is incorrect.

TORQUE SPECIFICATIONS

TORQUE SPECIFICATIONS TABLE

Application	Ft. Lbs. (N.m)
Ball Joint Type	
Lower Ball Joint Nut	
Jeep	100 (136)
Upper Ball Joint Nut	
Jeep	100 (136)
Upper Ball Joint Split Retaining Seat	
Jeep	50 (68)

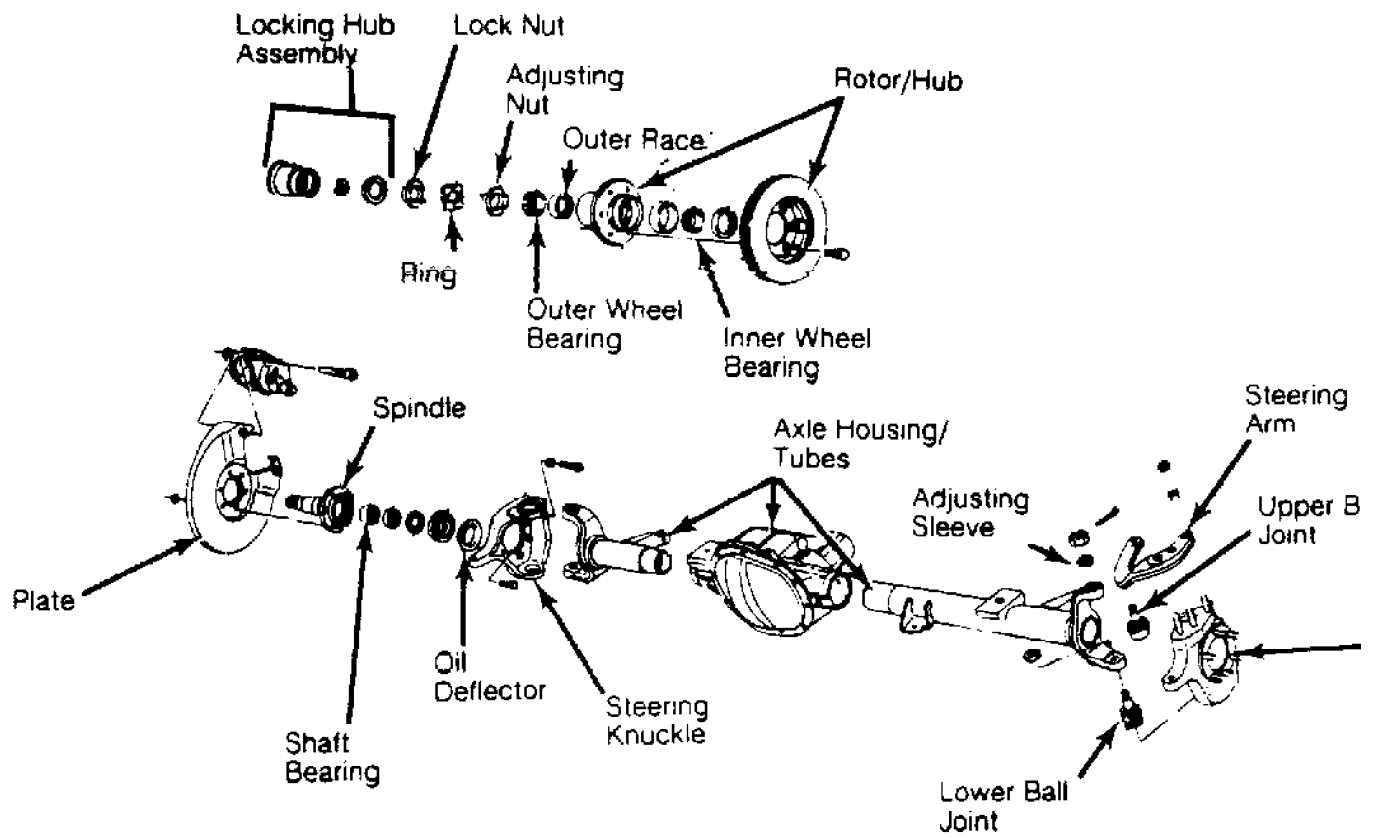

Fig. 2: Exploded View of Ball Joint Type Steering Knuckle Assembly